

NOTE:

1) No part of the subject parcel is located within a Special Flood Hazard Area (SFHA) as shown on the Federal Emergency Management Agency (FEMA), Flood Insurance Rate Map (FIRM), Community Name: Town of Durham, Number: 330146, Panel: 0318, Suffix: D, Effective Date: May 17, 2005.

ZONING BRIEF:

Zoning District = (RA) Residence-A
Dimensional Setbacks:
Front=30ft Side=10ft Rear=20ft
Wetland Conservation Overlay District
Wetland Buffer: 75ft

Wetland delineation
performed on 11/19/18
per Article XIII, Section 175-59B.

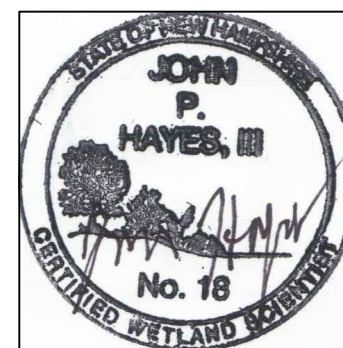

John P. Hayes III, CSS/CWS
7 Limestone Way
No. Hampton, NH 03862

PICTURE 1



PICTURE 2



PICTURE 3



TOTAL AREA
11,765 Sq Ft±
0.27 Acs±

OWNERS OF RECORD

Tax Map 6 Lot 4-12
(1 Hoitt Drive)
Emery J. & Elizabeth A. Johnston
PO Box 898
Newbury, Ma. 01951
See SCRD Bk: 4621 Pg: 542
See SCRD Pocket 7, Folder 5, Plan 1

SURVEY OF LAND BUILDERS PLOT PLAN for

**Emery J. &
Elizabeth A.
Johnston**

in
Durham, NH
Strafford County

January 2019
*Revised February 2019
Scale 1 inch = 20 feet

Landry Surveying, LLC

248 Mill Pond Road
Nottingham, NH 03290
(603) 679-1387

Job No. 1863

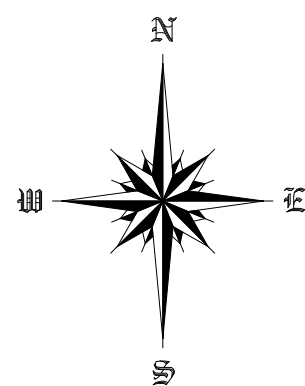

TAX MAP 6 LOT 3-36
(53-55A Mill Road)
Scott E. Guyer
PO Box 184
Portsmouth, NH 03802

TAX MAP 6 LOT 3-35
Nathan A. & Rachel K. Swanson
51 Mill Road
Durham, NH 03824

TAX MAP 6 LOT 4-13
(13 Oyster River Road)
Nicholas & Jenny Macheras
266 Chandler Road
Andover, Ma. 01810

TAX MAP 6 LOT 4-11
(3 Hoitt Drive)
College Rentals, LLC
5 Hoitt Drive
Durham, NH 03824

TAX MAP 6 LOT 4-16
(4 Hoitt Drive)
Yigal M. & Rivka Peeri
99 Shelton Road
Swampscott, Ma. 01907

TAX MAP 6 LOT 4-15
Kevin & Cristina Healey
2 Hoitt Drive
Durham, NH 03824

TAX MAP 6 LOT 4-14
Wourgiotis-Mathur
2017 Revocable Trust
15 Oyster River Road
Durham, NH 03824

HOITT DRIVE
(PUBLIC WAY - CLASS V)
(WITH PUBLIC WATER & SEWER)

LEGEND/SYMBOLS

SCRD Strafford County Registry of Deeds
Sq Ft Square Feet
Ac Acre
Fnd Found
Ret. Retaining
Conc. Concrete
Bnd Bound
UP Utility Pole & Number
OHU Over Head Utilities
PI Photo Number & Direction

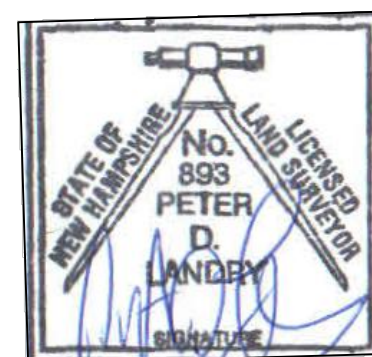

*REVISION: (2/19/19) - Changed Clarified Addition and Deck Dimensions.