

8/28/2015  
4:28:54 PM  
K:\90270502-CADD\IP\CutSheet\90270502\CLRplans.dgn

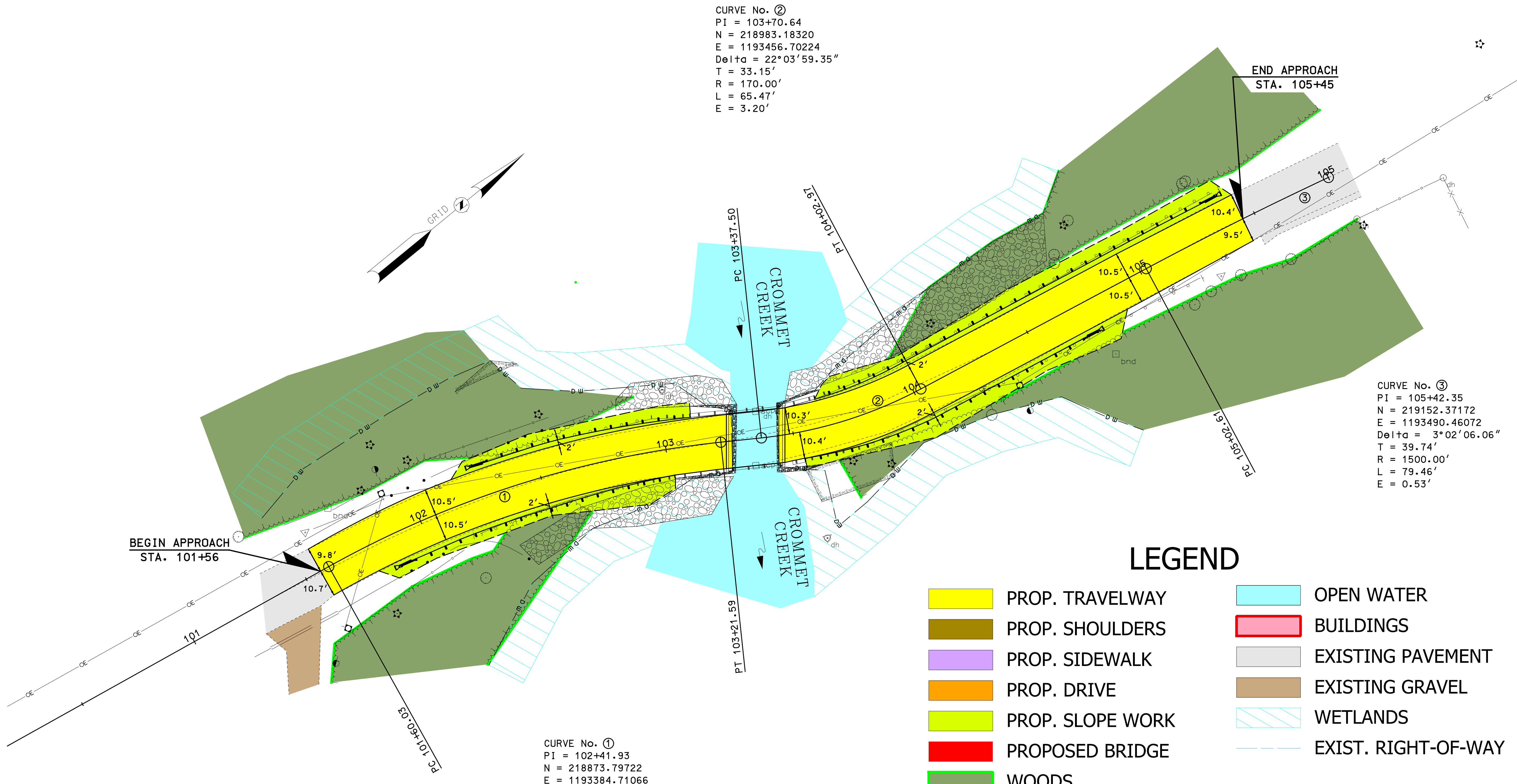

**CURVE No. ②**  
 PI = 103+70.64  
 N = 218983.18320  
 E = 1193456.70224  
 Delta = 22°03'59.35"  
 T = 33.15'  
 R = 170.00'  
 L = 65.47'  
 E = 3.20'

**CURVE No. ③**  
 PI = 105+42.35  
 N = 219152.37172  
 E = 1193490.46072  
 Delta = 3°02'06.06"  
 T = 39.74'  
 R = 1500.00'  
 L = 79.46'  
 E = 0.53'

**CURVE No. ①**  
 PI = 102+41.93  
 N = 218873.79722  
 E = 1193384.71066  
 Delta = 23°08'30.65"  
 T = 81.90'  
 R = 400.00'  
 L = 161.56'  
 E = 8.30'

CONCEPTUAL DESIGN  
 NOT FOR CONSTRUCTION  
 DATE SEP. 2015



### LEGEND

- PROP. TRAVELWAY
- PROP. SHOULDERS
- PROP. SIDEWALK
- PROP. DRIVE
- PROP. SLOPE WORK
- PROPOSED BRIDGE
- WOODS
- OPEN WATER
- BUILDINGS
- EXISTING PAVEMENT
- EXISTING GRAVEL
- WETLANDS
- EXIST. RIGHT-OF-WAY

REV.	DESCRIPTION	DATE	DRW	CHKD	BY
SEPTEMBER 2015					
DESIGN BY:	JFMS				
DRAWN BY:	JFMS				
CHKD. BY:	SBH				
SCALE:	AS SHOWN				
This document is prepared as an instrument of service and shall remain the property of Hoyle, Tanner, Inc. It may not be used, reproduced, disseminated or transferred in any manner, including electronically, for any other purpose than that project, without the written permission of Hoyle, Tanner, Inc.					
150 Dow Street, Manchester, NH 03101-1227 Tel (603) 669-5555 • Fax (603) 669-4188 <a href="http://www.hoyletanner.com">www.hoyletanner.com</a>					
TOWN OF DURHAM DURHAM, NEW HAMPSHIRE DURHAM POINT ROAD OVER CROMMET CREEK ROADWAY PLAN					
PROJECT NO.: 902705					
FILE NAME: 902705CLRplans					
MODEL NAME: 902705G01					
SHEET NO.					
1					
SHEET 1 OF 1					