

From: [Michael Behrendt](#)
Subject: Main Street #19 - wetland buffer
Date: Tuesday, February 22, 2022 10:17:20 AM

To the Conservation Commission and the Planning Board,
Dennis Meadows pointed out a 75 foot wetland buffer at the lower end of the site to the Conservation Commission. Please see the email chain below including an image of the site with a clarification from Mike Sievert. I thought the wetland at the far left off the property was under 3,000 square feet and thus exempt from the WCOD but that wetland actually extends further to the left/south (only this part was delineated) so it does exceed 3,000 square feet. At any rate, according to Mike Sievert nothing is proposed within that buffer.

Applicants are not required to delineate entire wetlands on adjacent lots, only to the extent that the wetland buffer is situated on the subject lot.

Michael Behrendt

Durham Town Planner
Town of Durham
8 Newmarket Road
Durham, NH 03824
(603) 868-8064
www.ci.durham.nh.us

From: Mike Sievert <msievert@horizonsengineering.com>
Sent: Tuesday, February 22, 2022 8:15 AM
To: Michael Behrendt <mbehrendt@ci.durham.nh.us>
Subject: RE: Main Street #19 - wetland

No, there will not be any work within the buffer.
Mike

Michael J. Sievert, PE
[Horizons Engineering, Inc.](#)

From: Michael Behrendt <mbehrendt@ci.durham.nh.us>
Sent: Monday, February 21, 2022 1:21 PM
To: Mike Sievert <msievert@horizonsengineering.com>
Subject: RE: Main Street #19 - wetland

Thanks Mike. Do you expect any activity within the 75 foot buffer as part of the project or during development? The retaining wall is just slightly beyond.

Michael Behrendt

Durham Town Planner
Town of Durham
8 Newmarket Road
Durham, NH 03824
(603) 868-8064
www.ci.durham.nh.us

From: Mike Sievert <msievert@horizonsengineering.com>
Sent: Monday, February 21, 2022 1:01 PM
To: Michael Behrendt <mbehrendt@ci.durham.nh.us>
Subject: RE: Main Street #19 - wetland

The 75' buffer is from the wetland that is off the property, not the small one on the property. You are correct, the one on the property is less than 3000sf but the one off the property is larger than 3000sf. Now that I am looking at that wetland off the property, the line on the rear should not be connected, not sure why that is connected because the wetland extends down towards the Chesley path, but we didn't have Mark West delineate the whole thing because it is off the property.
M

Michael J. Sievert PE
[Horizons Engineering, Inc.](#)

From: Michael Behrendt <mbehrendt@ci.durham.nh.us>
Sent: Monday, February 21, 2022 12:42 PM
To: Mike Sievert <msievert@horizonsengineering.com>
Subject: Main Street #19 - wetland

Hi Mike,
Why is a 75 foot wetland buffer shown on the site plan? The wetland is less than 3,000 square feet and so exempt unless it is a vernal pool. Thanks.

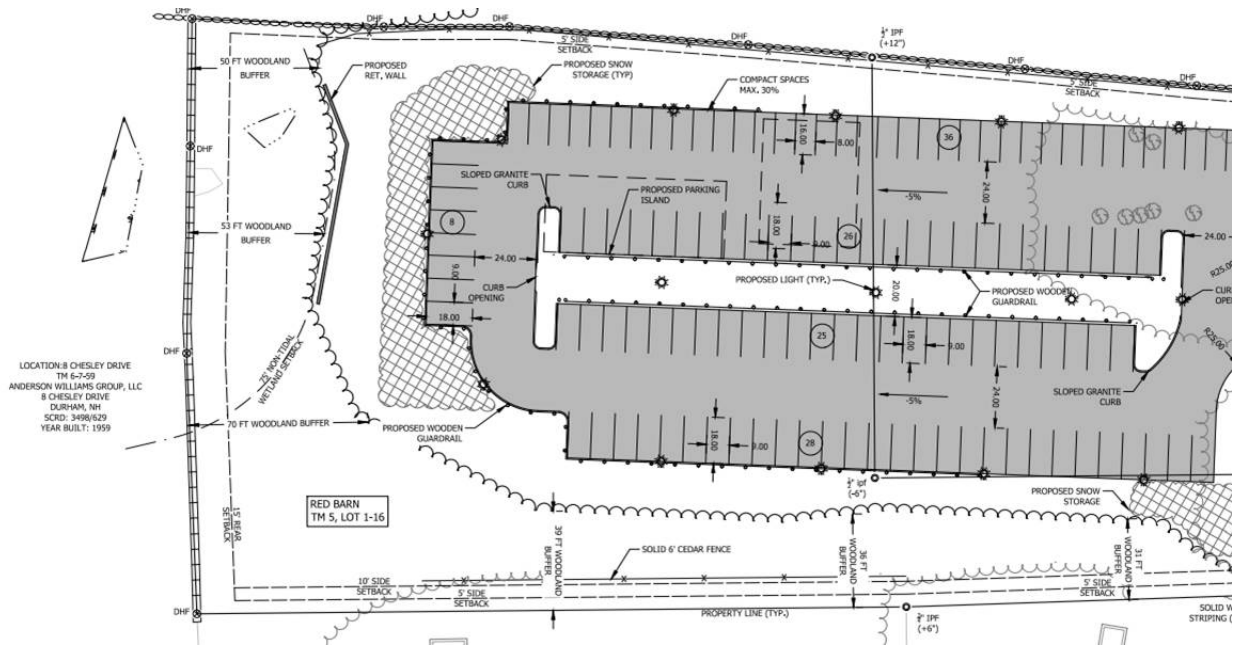

Michael Behrendt
 Durham Town Planner
 Town of Durham
 8 Newmarket Road
 Durham, NH 03824
 (603) 868-8064
www.ci.durham.nh.us