



D-Series VC Size 0 LED Area Luminaire

d^{series}



Specifications

EPA:	0.95 ft ² (.09 m ²)
Length:	26" (66.0 cm)
Width:	13" (33.0 cm)
Height:	7" (17.8 cm)
Weight (max):	16 lbs (7.25 kg)

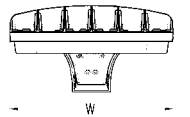
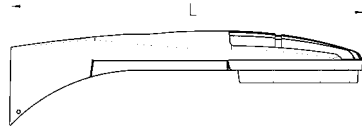
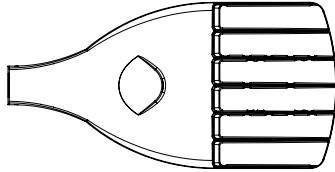

A+ Capable options indicated by this color background.

Catalog Number
Notes
Type

Hit the Tab key or mouse over the page to see all interactive elements.

Capable Luminaire

This item is an A+ capable luminaire, which has been designed and tested to provide consistent color appearance and system-level interoperability.

- All configurations of this luminaire meet the Acuity Brands' specification for chromatic consistency
- This luminaire is A+ Certified when ordered with DTL[®] controls marked by a **shaded background**. DTL DLL equipped luminaires meet the A+ specification for luminaire to photocontrol interoperability¹
- This luminaire is part of an A+ Certified solution for ROAM[®] or XPoint[™] Wireless control networks, providing out-of-the-box control compatibility with simple commissioning, when ordered with drivers and control options marked by a **shaded background**¹

To learn more about A+, visit www.acuitybrands.com/aplus.

- See ordering tree for details.
- A+ Certified Solutions for ROAM require the order of one ROAM node per luminaire. Sold Separately: [Link to Roam](#); [Link to DTL DLL](#)

Ordering Information

EXAMPLE: DSX0 LED P3 30K VLS MVOLT SPA FAO DDBXD

DSX0 LED	Series	Lumen Package	Color temperature	Distribution	Voltage	Mounting
DSX0 LED	P1	6,000 Lumen Package	30K 3000 K	VLS Symmetric	MVOLT ¹	Shipped included
	P2	8,700 Lumen Package	40K 4000 K		120 ²	SPA Square pole mounting
	P3	12,000 Lumen Package	50K 5000 K		208 ²	RPA Round pole mounting
					240 ²	WBA Wall bracket
					277 ²	SPUMBA Square pole universal mounting adaptor ⁴
					347 ^{2,3}	RPUMBA Round pole universal mounting adaptor ⁴
					480 ^{2,3}	Shipped separately
						KMA8 DDBXD U Mast arm mounting bracket adaptor (specify finish) ⁵

Control options	Other options	Finish (required)
Shipped installed	Shipped installed	DDBXD Dark bronze
NLTAIR2 nLight AIR generation 2 enabled ⁶	SF Single fuse (120, 277, 347V) ²	DBLXD Black
PER NEMA twist-lock receptacle only (no controls) ⁷	DF Double fuse (208, 240, 480V) ²	DNAXD Natural aluminum
PER5 Five-wire receptacle only (no controls) ^{7,8}	FBZ Flat bezel	DWHXD White
PER7 Seven-wire receptacle only (no controls) ^{7,8}	Shipped separately	DDBTXD Textured dark bronze
DMG 0-10V dimming driver (no controls)	HS House-side shield ^{16,17,18}	DBLBXD Textured black
PIR Bi-level, motion/ambient sensor, 8-15' mounting height, ambient sensor enabled at 5fc ^{9,10}	BS Bird spikes ¹⁶	DNATXD Textured natural aluminum
PIRH Bi-level, motion/ambient sensor, 15-30' mounting height, ambient sensor enabled at 5fc ^{9,10}	WG Wireguard ^{16,18}	DWHGXD Textured white
PIRHN Network, Bi-Level motion/ambient sensor ¹¹		
PIR1FC3V Bi-level, motion/ambient sensor, 8-15' mounting height, ambient sensor enabled at 1fc ^{9,10}		
PIRH1FC3V Bi-level, motion/ambient sensor, 15-30' mounting height, ambient sensor enabled at 1fc ^{9,10}		
BL30 Bi-level switched dimming, 30% ^{12,13}		
BL50 Bi-level switched dimming, 50% ^{12,13}		
PNMTDD3 Part night, dim till dawn ¹⁴		
PNMT5D3 Part night, dim 5 hrs ¹⁴		
PNMT6D3 Part night, dim 6 hrs ¹⁴		
PNMT7D3 Part night, dim 7 hrs ¹⁴		
FAO Field adjustable output ¹⁵		



Accessories

Ordered and shipped separately.

Controls & Shields

DLL127F 1.5 JU	Photozell - SSL twist-lock (120-277V) ¹⁹
DLL347F 1.5 CUL JU	Photozell - SSL twist-lock (347V) ¹⁹
DLL480F 1.5 CUL JU	Photozell - SSL twist-lock (480V) ¹⁹
PUMBA DDBXD U*	Square and round pole universal mounting bracket adaptor (specify finish) ²⁰
KMA8 DDBXD U	Mast arm mounting bracket adaptor (specify finish) ⁵

For more control options, visit [DTL](#) and [ROAM](#) online.

NOTES

- MVOLT driver operates on any line voltage from 120-277V (50/60 Hz).
- Single fuse (SF) requires 120V, 277V or 347V. Double fuse (DF) requires 208V, 240V or 480V.
- Not available with BL30, BL50 or PNMT options.
- Existing drilled pole only. Available as a separate combination accessory; for retrofit use only; PUMBA (finish) U; 1.5 G vibration load rating per ANCI C136.31.
- Must order fixture with SPA mounting. Must be ordered as a separate accessory; see Accessories information. For use with 2-3/8" mast arm (not included).
- Must be ordered with PIRHN.
- Photozell ordered and shipped as a separate line item from Acuity Brands Controls. See accessories. Shorting Cap included.
- If ROAM® node required, it must be ordered and shipped as a separate line item from Acuity Brands Controls. Shorting Cap included.
- Reference Motion Sensor table on page 3.
- Reference Motion Sensor Default Settings on page 3 to see functionality.
- Must be ordered with NLTAIR2. For more information on nLight Air 2 [visit this link](#).
- Requires (2) separately switched circuits.
- Not available with 347V, 480V, PNMT. For PER5 or PER7 see PER Table on page 3.
- Not available with 347V, 480V, BL30 and BL50. For PER5 or PER7 see PER Table on page 3. Separate Dusk to Dawn required.
- Not available with other dimming controls options with isolated neutrals.
- Must be ordered with fixture for factory pre-drilling. Not field installable.
- HS available in black only.
- HS not available with WG option
- Requires luminaire to be specified with PER option. See PER Table.
- For retrofit use only.

Drilling

Template #8

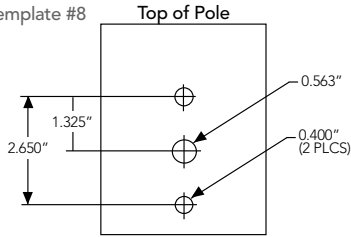

DSX0 shares a unique drilling pattern with the AERIS™ family. Specify this drilling pattern when specifying poles, per the table below.

DM19AS	Single unit	DM29AS	2 at 90°**
DM28AS	2 at 180°	DM39AS	3 at 90°**
DM49AS	4 at 90°**	DM32AS	3 at 120°**

Example: SSA 20 4C DM19AS DDBXD

Visit Lithonia Lighting's [POLES CENTRAL](#) to see our wide selection of poles, accessories and educational tools.

*Round pole top must be 3.25" O.D. minimum.
**For round pole mounting (RPA) only.

Tenon Mounting Slipfitter**

Tenon O.D.	Single Unit	2 at 180°	2 at 90°	3 at 120°	3 at 90°	4 at 90°
2-3/8"	AST20-190	AST20-280	AST20-290	AST20-320		
2-7/8"	AST25-190	AST25-280	AST25-290	AST25-320		
4"	AST35-190	AST35-280	AST35-290	AST35-320	AST35-390	AST35-490

Motion Sensor Default Settings (Any other presets require an RFD)

Option	Dimmed State	High Level (when triggered)	Photocell Operation	Dwell Time	Ramp-up Time	Ramp-down Time
*PIR or PIRH	3V (37%) Output	10V (100%) Output	Enabled @ 5FC	3 sec	5 min	5 min
PIR3FC3V or PIRH3FC3V	3V (37%) Output	10V (100%) Output	Enabled @ 3FC	3 sec	5 min	5 min

*for use with Inline Dusk to Dawn or timer

HANDHOLE ORIENTATION

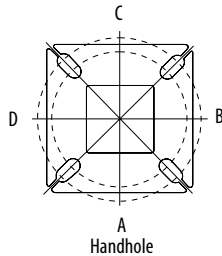

Pole drilling nomenclature: # of heads at degree from handhole (default side A)

Code	DM19AS	DM28AS	DM29AS	DM32AS	DM39AS	DM49AS
1 @ 90°		2 @ 280°	2 @ 90°	3 @ 120°	3 @ 90°	4 @ 90°
Side B		Side B & D	Side B & C	Round pole only	Side B, C, & D	Sides A, B, C, D

Note: Review luminaire spec sheet for specific nomenclature

PER Table

Control	PER (3 wire)	PER5 (5 wire)		PER7 (7 wire)	
		Wire 4/Wire5	Wire 4/Wire5	Wire 4/Wire5	Wire 6/Wire7
Photocontrol Only (On/Off)	✓	⚠	Wired to dimming leads on driver	⚠	Wired to dimming leads on driver Wires Capped inside fixture
ROAM	⊘	✓	Wired to dimming leads on driver	⚠	Wired to dimming leads on driver Wires Capped inside fixture
ROAM with Motion (ROAM on/off only)	⊘	⚠	Wired to dimming leads on driver	⚠	Wired to dimming leads on driver Wires Capped inside fixture
Futureproof*	⊘	⚠	Wired to dimming leads on driver	✓	Wired to dimming leads on driver Wires Capped inside fixture
Futureproof* with Motion	⊘	⚠	Wired to dimming leads on driver	✓	Wired to dimming leads on driver Wires Capped inside fixture

- ✓ Recommended
- ⊘ Will not work
- ⚠ Alternate

*Futureproof means: Ability to change controls in the future.

Photometric Diagrams

To see complete photometric reports or download .ies files for this product, visit Lithonia Lighting's [D-Series Area Size 0 homepage](#).

Isofootcandle plots for the DSX0 LED 40C 1000 40K. Distances are in units of mounting height (20').

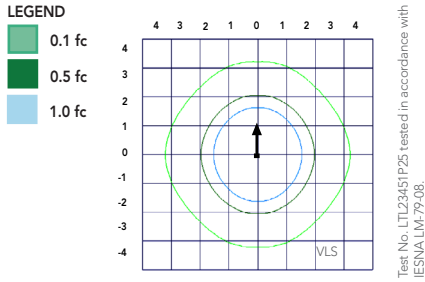

Performance Data

Lumen Ambient Temperature (LAT) Multipliers

Use these factors to determine relative lumen output for average ambient temperatures from 0-40°C (32-104°F).

Ambient		Lumen Multiplier
0°C	32°F	1.04
10°C	50°F	1.02
20°C	68°F	1.01
25°C	77°F	1.00
30°C	86°F	0.99
40°C	104°F	0.98

Electrical Load

Number of LEDs	System Watts	Current (A)					
		120	208	240	277	347	480
P1	56	0.48	0.28	0.24	0.22	0.17	0.14
P2	83	0.70	0.40	0.35	0.30	0.25	0.18
P3	116	0.96	0.55	0.48	0.42	0.34	0.24

Projected LED Lumen Maintenance

Data references the extrapolated performance projections for the platforms noted in a **25°C ambient**, based on 10,000 hours of LED testing (tested per IESNA LM-80-08 and projected per IESNA TM-21-11).

To calculate LLF, use the lumen maintenance factor that corresponds to the desired number of operating hours below. For other lumen maintenance values, contact factory.

Operating Hours	0	25,000	50,000	100,000
Lumen Maintenance Factor	DSX0 LED P1			
	1.0	0.96	0.93	0.86
	DSX0 LED P2			
	1.0	0.96	0.92	0.84
	DSX0 LED P3			
	1.0	0.96	0.90	0.81

Lumen Output

Lumen values are from photometric tests performed in accordance with IESNA LM-79-08. Data is considered to be representative of the configurations shown, within the tolerances allowed by Lighting Facts. Contact factory for performance data on any configurations not shown here.

Performance Package	System Watts	Distribution Type	30K					40K					50K				
			Lumens	B	U	G	LPW	Lumens	B	U	G	LPW	Lumens	B	U	G	LPW
P1	56	VLS	5,420	2	0	1	97	5,777	2	0	1	103	5,835	2	0	1	104
		VLS w/ FBZ	5,765	2	0	1	103	6,145	2	0	1	110	6,206	2	0	1	111
P2	83	VLS	7,974	3	0	1	96	8,499	3	0	2	102	8,584	3	0	2	103
		VLS w/ FBZ	8,481	3	0	1	102	9,040	3	0	1	109	9,130	3	0	1	110
P3	116	VLS	10,911	3	0	2	94	11,630	3	0	2	100	11,746	3	0	2	101
		VLS w/ FBZ	11,605	3	0	1	100	12,370	3	0	1	107	12,494	3	0	1	108

FEATURES & SPECIFICATIONS

INTENDED USE

The sleek design of the D-Series Size 0 reflects the embedded high performance LED technology. It is ideal for many commercial and municipal applications, such as parking lots, plazas, campuses, and pedestrian areas.

CONSTRUCTION

Single-piece die-cast aluminum housing has integral heat sink fins to optimize thermal management through conductive and convective cooling. Modular design allows for ease of maintenance and future light engine upgrades. The LED driver is mounted in direct contact with the casting to promote low operating temperature and long life. Housing is completely sealed against moisture and environmental contaminants (IP65). Low EPA (0.95 ft²) for optimized pole wind loading.

FINISH

Exterior parts are protected by a zinc-infused Super Durable TGIC thermoset powder coat finish that provides superior resistance to corrosion and weathering. A tightly controlled multi-stage process ensures a minimum 3 mils thickness for a finish that can withstand extreme climate changes without cracking or peeling. Available in both textured and non-textured finishes.

OPTICS

Precision-molded proprietary acrylic lenses are engineered for superior area lighting distribution, uniformity, and pole spacing. Light engines are available in 3000 K, 4000 K or 5000 K (80 CRI) configurations. The D-Series Size 0 has zero uplight and qualifies as a Nighttime Friendly™ product, meaning it is consistent with the LEED® and Green Globes™ criteria for eliminating wasteful uplight.

ELECTRICAL

Light engine(s) configurations consist of high-efficacy LEDs mounted to metal-core circuit boards to maximize heat dissipation and promote long life (up to L86/100,000 hours at 25°C). Class 1 electronic drivers are designed to have a power factor >90%, THD <20%, and an expected life of 100,000 hours with <1% failure rate. Easily serviceable 10kV surge protection device meets a minimum Category C Low operation (per ANSI/IEEE C62.41.2).

INSTALLATION

Included mounting block and integral arm facilitate quick and easy installation. Stainless steel bolts fasten the mounting block securely to poles and walls, enabling the D-Series Size 0 to withstand up to a 3.0 G vibration load rating per ANSI C136.31. The D-Series Size 0 utilizes the AERIS™ series pole drilling pattern (template #8). Optional terminal block, tool-less entry, and NEMA photocontrol receptacle are also available.

LISTINGS

UL Listed for wet locations. Light engines are IP66 rated; luminaire is IP65 rated. Rated for -40°C minimum ambient. U.S. Patent No. D672,492 S. International patent pending.

DesignLights Consortium® (DLC) qualified product. Not all versions of this product may be DLC qualified. Please check the DLC Qualified Products List at www.designlights.org to confirm which versions are qualified.

International Dark-Sky Association (IDA) Fixture Seal of Approval (FSA) is available for all products on this page utilizing 3000K color temperature only.

International Dark-Sky Association (IDA) Fixture Seal of Approval (FSA) is available for all products on this page utilizing 3000K color temperature only.

WARRANTY

5-year limited warranty. Complete warranty terms located at: www.acuitybrands.com/CustomResources/Terms_and_conditions.aspx

Note: Actual performance may differ as a result of end-user environment and application. All values are design or typical values, measured under laboratory conditions at 25 °C. Specifications subject to change without notice.

