

WEST 
ENVIRONMENTAL INC.

48 Stevens Hill Road, Nottingham, NH 03290
603-734-4298 ♦ mark@westenv.net

Memorandum

RECEIVED
Town of Durham
FEB - 5 2021
Planning, Assessing
and Zoning

February 5, 2021

To: Durham Conservation Commission and Planning Board

From: Mark West, West Environmental

RE: Mulhern Subdivision, Durham, NH

SUBJ: Existing Impacts to Wetland 1

This memo is sent to understand the previous impacts to Wetland 1 resulting from the construction of Gerrish Drive and Ambler Way and the driveways to the White and Kelley parcels. We worked with MJS Engineering, PC to identify the impacts on the attached plan. The larger impact 6307 SF includes the road and the White driveway, and the smaller impact 1,073 SF is for the Kelley driveway crossing.

We utilized the existing wetland delineation and researched aerial photos, old topo maps, and LiDAR maps to estimate the existing impacts to this wetland (See attached). 1962 aerial, LiDAR map and topographic map.

The result is 7,380 square feet of previous impact to this wetland including the placement of four culverts three of which are a part of road or driveway crossings. This is an important component of the Wetland Functional Assessment as it demonstrates that even with this impact similar in size to the proposed crossing, Wetland 1 still provides wetland functions. The stream continues to flow both upslope and downslope of the impact areas despite the relocation of the stream channel into ditches at the larger crossing. This will also be the case after when the new road is built.

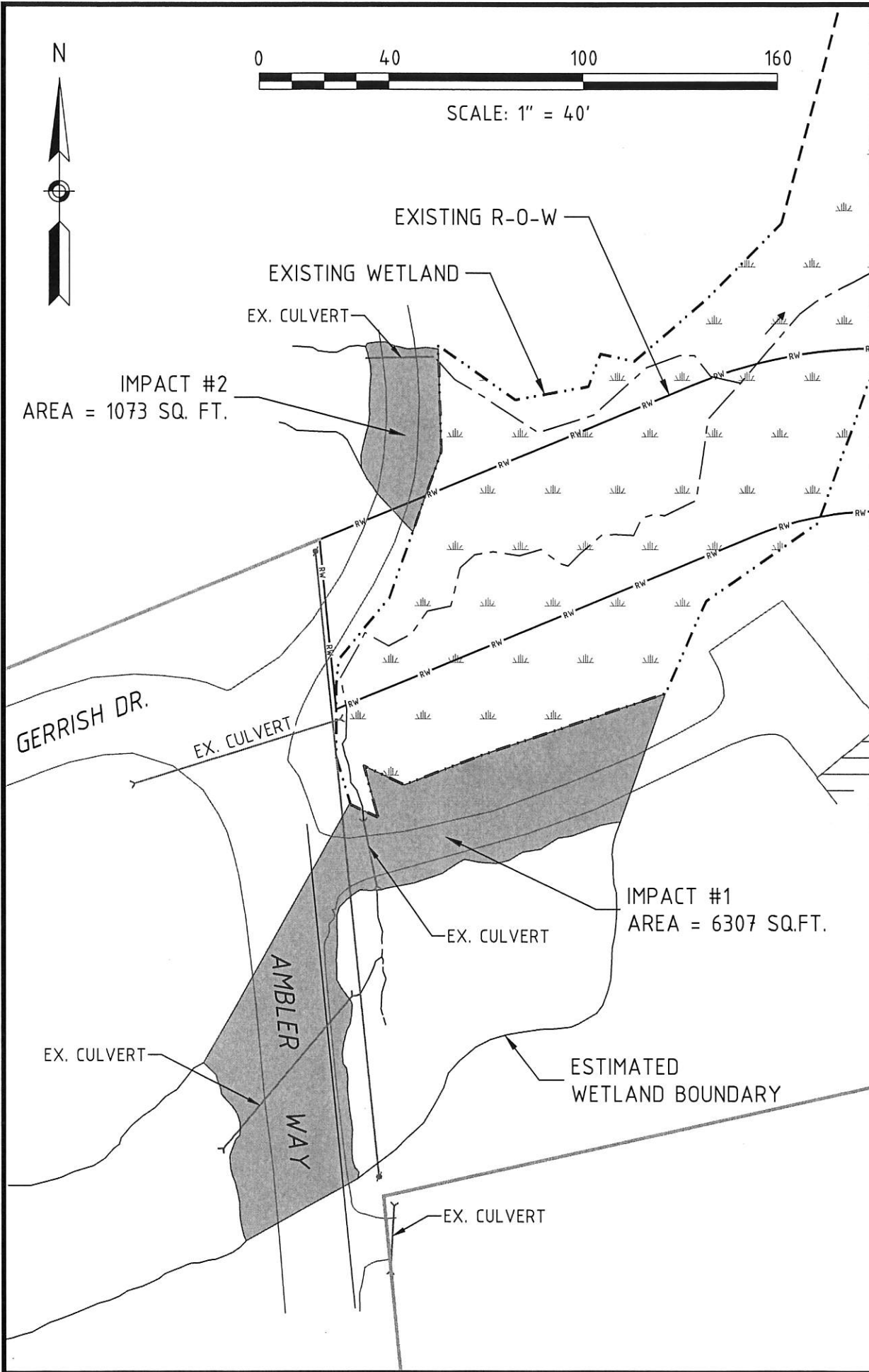

DATE:	2/5/21	SCALE:	1"=40'
DESIGNER:	-	DRAWN BY:	MCS
APPROVED BY:	MJS	DRAWING FILE:	

HISTORIC WETLAND IMPACT PLAN
prepared for
MULHERN
 TAX MAP 10, LOT 8-6
 93 BAGDAD ROAD, DURHAM, NH 03824



MJS ENGINEERING, P.C.
 CIVIL • STRUCTURAL • ENVIRONMENTAL
 5 Railroad St., P.O. Box 359
 Newmarket, NH 03857
 Phone: (603) 659-4979, Fax: (603) 659-4627
 E-mail: mjs@mjs-engineering.com

JOB: 19-063
EXHIBIT-1

