

# Mill Plaza Redevelopment

## DURHAM, NEW HAMPSHIRE

PERMIT DRAWINGS  
APRIL 3, 2020

LIST OF DRAWINGS

- L00.1

LANDSCAPE PROPOSED PLAN  
DIFFERENCES WITH PREVIOUSLY  
SUBMITTED PERMIT PLAN
- L00.2

LANDSCAPE PROPOSED PLAN
- L00.3

LANDSCAPE PROPOSED PLAN  
WITH PARKING AND LANDSCAPE  
AREAS
- L00.4

LANDSCAPE PROPOSED PLAN  
WITH PARKING AREA TREE  
DESIGNATIONS
- L00.5

LANDSCAPE PROPOSED PLAN  
WITH PARKING AREA AND  
LANDSCAPE AREA ANALYSIS
- L00.6

LANDSCAPE PROPOSED PLAN  
WITH PARKING AREA AND  
LANDSCAPE AREA ANALYSIS

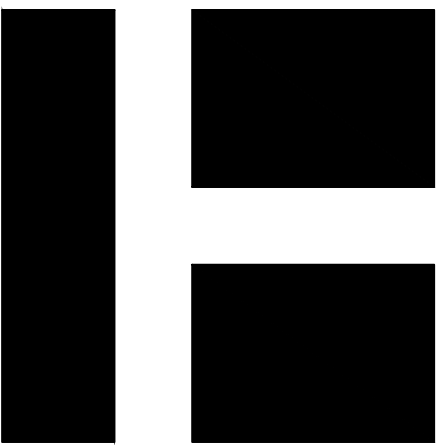

HARRIMAN

AUBURN BOSTON PORTLAND PORTSMOUTH

Mill Plaza  
Redevelopment

Durham, New Hampshire

Harriman Project No.

16117

Key Plan

PERMIT DRAWINGS

APRIL 3, 2020

Rev Date	Revision Description

PRELIMINARY  
NOT FOR  
CONSTRUCTION

PA / PE: MJB	© 2020 Harriman Associates
Drawn By: HAS	

COVER SHEET

G00.1



Plotted On: Mar 31, 2020-10:53am By: hnsnyder

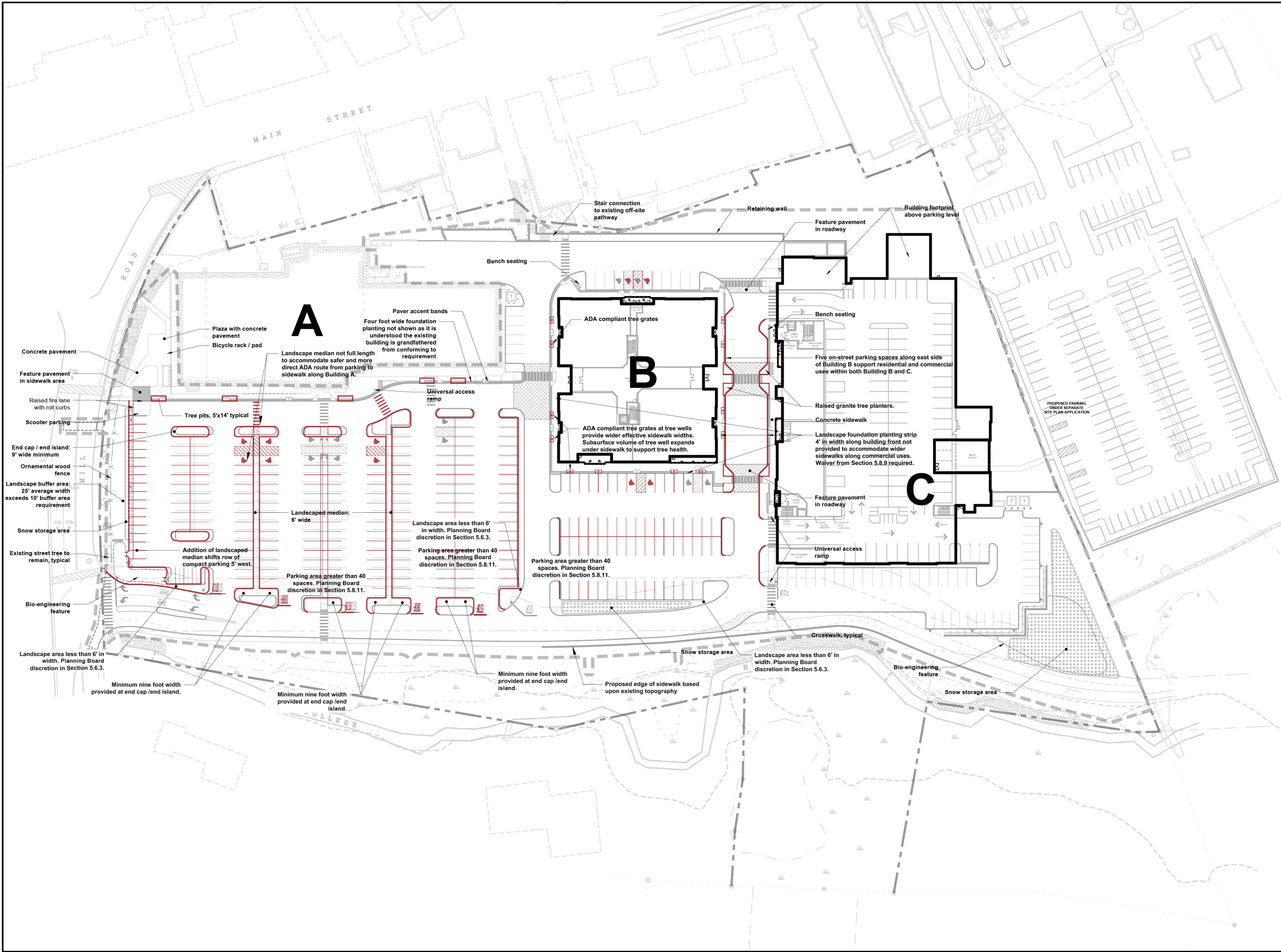

Harriman Project No. 16117

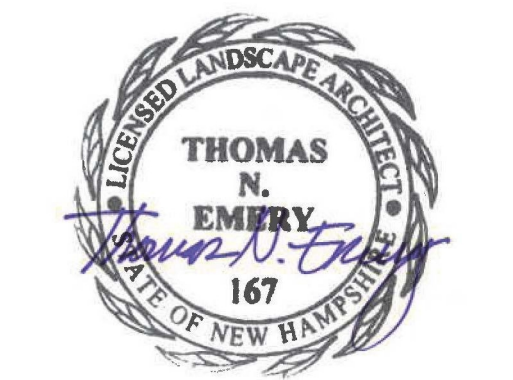

**PERMIT DRAWINGS  
NOT FOR CONSTRUCTION**

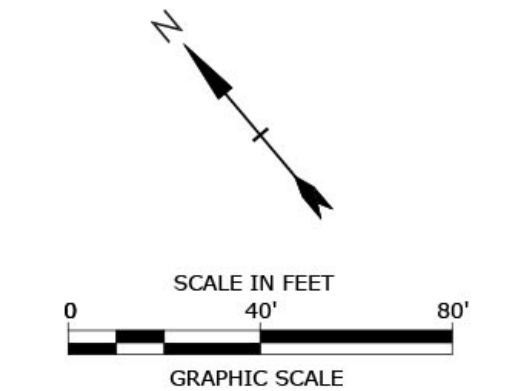

## Mill Plaza Redevelopment

Colonial Durham  
Associates, LP

7 Mill Road, Unit L  
Durham,  
New Hampshire 03824

MARK	DATE	DESCRIPTION
PROJECT NO:	M1529-002	
DATE:	04/03/20	
FILE:		
DRAWN BY:	HAS/TNE	
CHECKED:	HAS/TNE	
APPROVED:		
LANDSCAPE PROPOSED PLAN DIFFERENCES WITH PREVIOUSLY SUBMITTED PERMIT PLAN SCALE: AS SHOWN		

**L00.1**



Plotted On: Mar 31, 2020-10:53am By: hnsyde

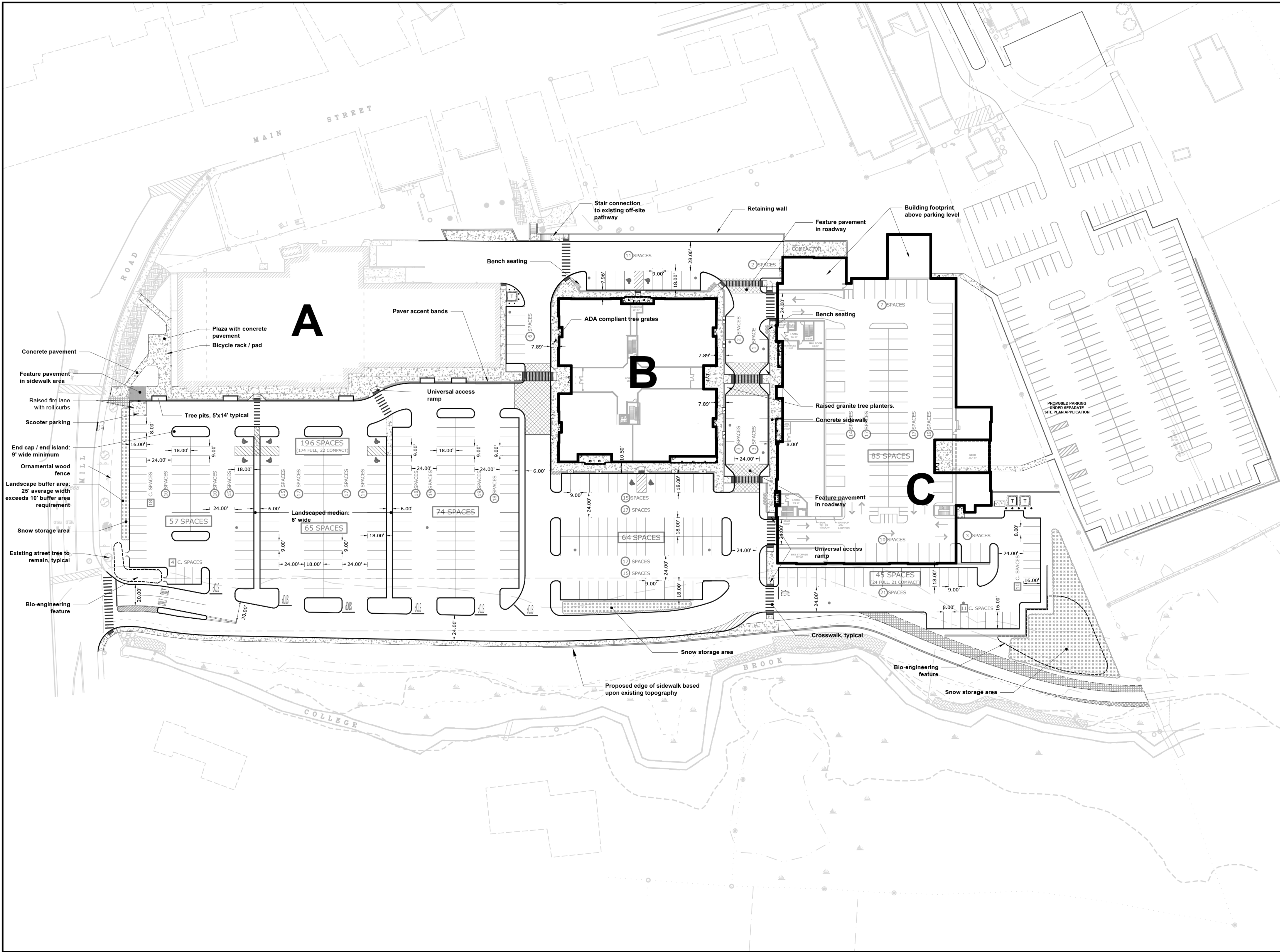

Harriman Project No. 16117

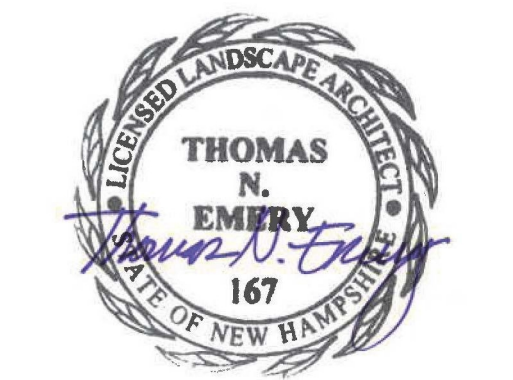

**PERMIT DRAWINGS  
NOT FOR CONSTRUCTION**

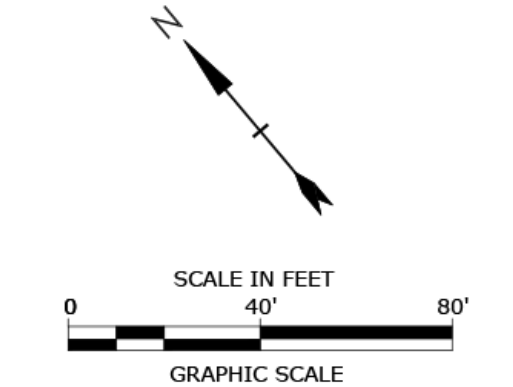

## Mill Plaza Redevelopment

Colonial Durham  
Associates, LP

7 Mill Road, Unit L  
Durham,  
New Hampshire 03824

MARK	DATE	DESCRIPTION
PROJECT NO:	M1529-002	
DATE:	04/03/20	
FILE:		
DRAWN BY:	HAS/TNE	
CHECKED:	HAS/TNE	
APPROVED:		

LANDSCAPE  
PROPOSED PLAN

SCALE: AS SHOWN

**L00.2**





Harriman Project No. 16117

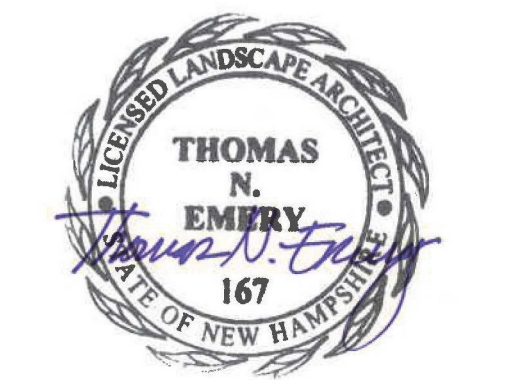

PERMIT DRAWINGS  
NOT FOR CONSTRUCTION

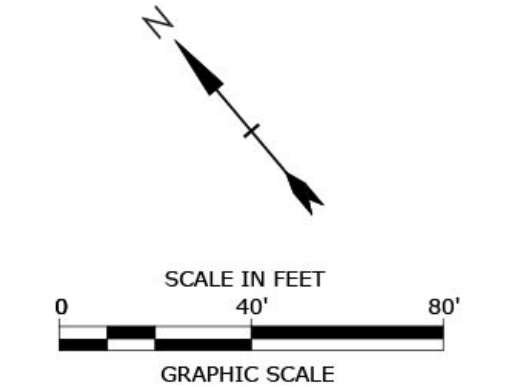

Mill Plaza  
Redevelopment

Colonial Durham  
Associates, LP

7 Mill Road, Unit L  
Durham,  
New Hampshire 03824

MARK	DATE	DESCRIPTION
PROJECT NO:	M1529-002	
DATE:	04/03/20	
FILE:		
DRAWN BY:	HAS/TNE	
CHECKED:	HAS/TNE	
APPROVED:		

LANDSCAPE  
PROPOSED PLAN  
WITH  
PARKING AND LANDSCAPE AREAS  
SCALE: AS SHOWN

L00.3

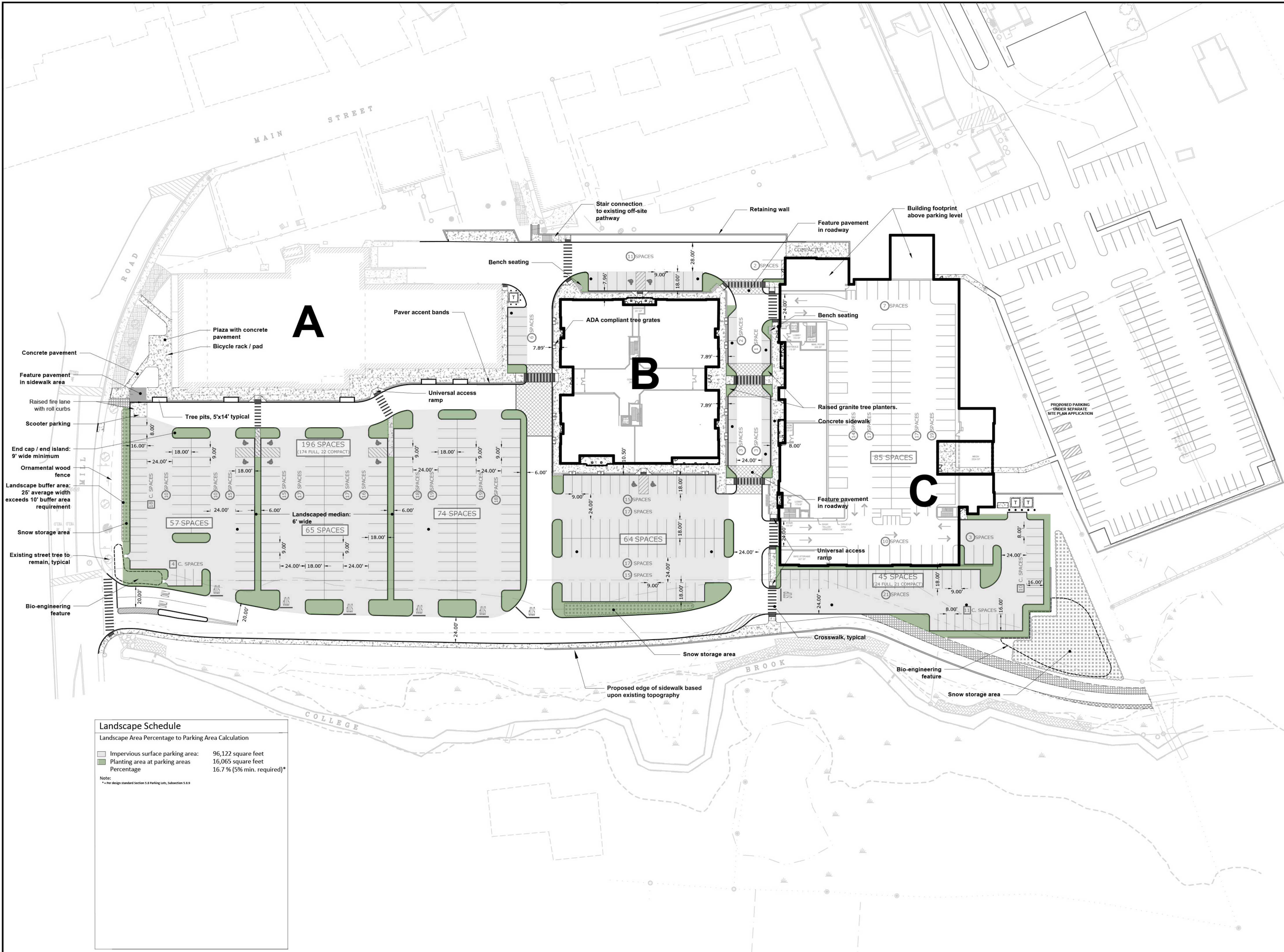

Landscape Schedule	
Landscape Area Percentage to Parking Area Calculation	
Impervious surface parking area:	96,122 square feet
Planting area at parking areas	16,065 square feet
Percentage	16.7 % (5% min. required)*
Note: * = Per design standard Section 5.8 Parking Lots, Subsection 5.8.9	



Plotted On: Mar 31, 2020 - 10:53am By: hnsyde

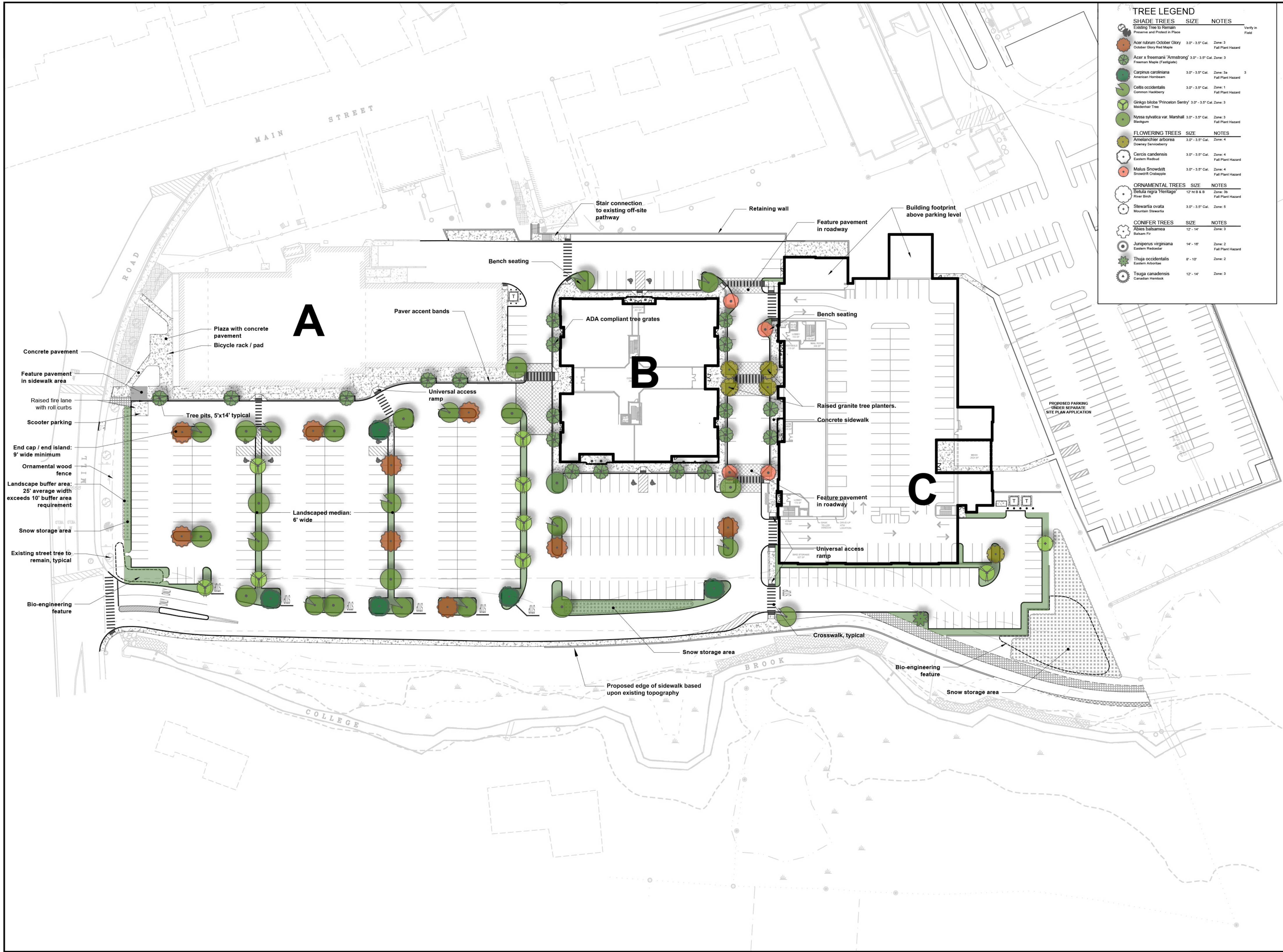

TREE LEGEND			
SHADE TREES		SIZE	NOTES
Existing Tree to Remain			
Preserve and Protect in Place			
Verify in Field			
	Acer rubrum October Glory	3.0' - 3.5' Cal.	Zone: 3
	October Glory Red Maple		Fall Plant Hazard
	Acer x freemanii 'Armstrong'	3.0' - 3.5' Cal.	Zone: 3
	Freeman Maple (Fastgate)		
	Carpinus caroliniana	3.0' - 3.5' Cal.	Zone: 3a
	American Hornbeam		Fall Plant Hazard
	Celtis occidentalis	3.0' - 3.5' Cal.	Zone: 1
	Common Hackberry		Fall Plant Hazard
	Ginkgo biloba 'Princeton Sentry'	3.0' - 3.5' Cal.	Zone: 3
	Medicinal Tree		
	Nyssa sylvatica var. Marshall	3.0' - 3.5' Cal.	Zone: 3
	Blackgum		Fall Plant Hazard
FLOWERING TREES		SIZE	NOTES
Downey Serviceberry			
	Amelanchier arborea	3.0' - 3.5' Cal.	Zone: 4
	Cercis canadensis	3.0' - 3.5' Cal.	Zone: 4
	Eastern Redbud		Fall Plant Hazard
	Malus Snowdrift	3.0' - 3.5' Cal.	Zone: 4
	Snowdrift Crabapple		Fall Plant Hazard
ORNAMENTAL TREES		SIZE	NOTES
	Betula nigra 'Heritage'	12' M 8 & 8	Zone: 3b
	River Birch		Fall Plant Hazard
	Stewartia ovata	3.0' - 3.5' Cal.	Zone: 5
	Mountain Stewartia		
CONIFER TREES		SIZE	NOTES
Balsam Fir			
	Abies balsamea	12' - 14'	Zone: 3
	Juniperus virginiana	14' - 16'	Zone: 5
	Eastern Redcedar		Fall Plant Hazard
	Thuja occidentalis	8' - 10'	Zone: 2
	Tsuga canadensis	12' - 14'	Zone: 3
	Canadian Hemlock		

**Tighe&Bond**  
Engineers | Environmental Specialists



HARRIMAN

AUBURN PORTLAND PORTSMOUTH BOSTON

Harriman Project No. 16117

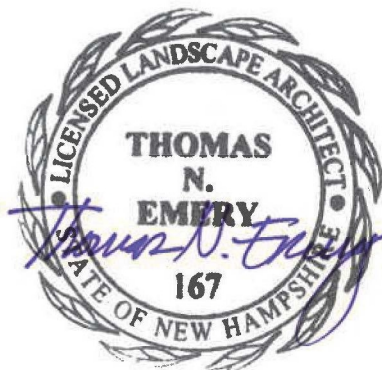

**PERMIT DRAWINGS**  
**NOT FOR CONSTRUCTION**

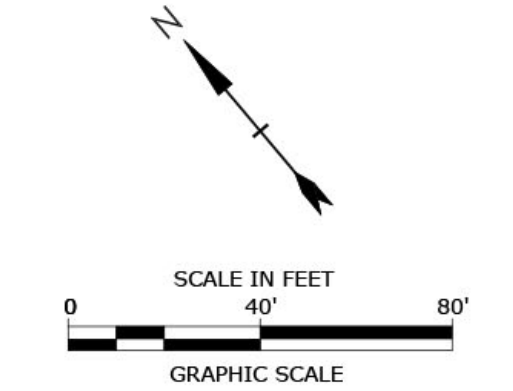

## Mill Plaza Redevelopment

Colonial Durham  
Associates, LP

7 Mill Road, Unit L  
Durham,  
New Hampshire 03824

MARK	DATE	DESCRIPTION
PROJECT NO:	M1529-002	
DATE:	04/03/20	
FILE:		
DRAWN BY:	HAS/TNE	
CHECKED:	HAS/TNE	
APPROVED:		
LANDSCAPE PROPOSED PLAN WITH PARKING AREA TREE DESIGNATIONS		
SCALE:	AS SHOWN	

**L00.4**





Harriman Project No. 16117

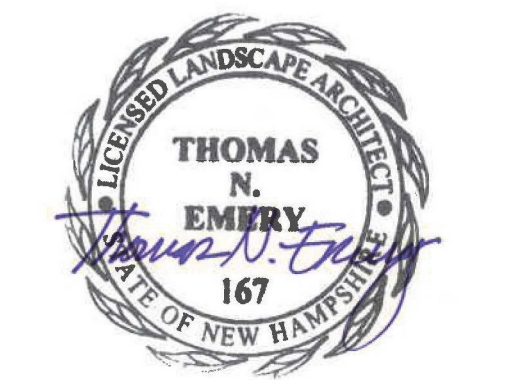

PERMIT DRAWINGS  
NOT FOR CONSTRUCTION

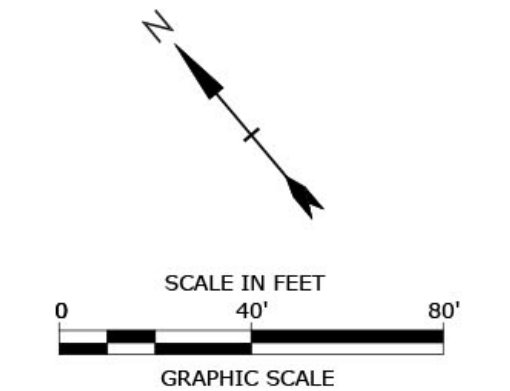

Mill Plaza  
Redevelopment

Colonial Durham  
Associates, LP

7 Mill Road, Unit L  
Durham,  
New Hampshire 03824

Landscape Schedule

Landscape Area Percentage to Parking Area Calculation

Impervious surface parking area:	96,122 square feet
Planting area at parking areas	16,065 square feet
Percentage	16.7 % (5% min. required)*

Note:  
\* = Per design standard Section 5.8 Parking Lots, Subsection 5.8.8

Parking Areas Breakdown:

Parking Area A:	
Impervious surface parking area:	58,165 square feet
Planting area at parking areas	8,547 square feet
Landscape Percentage	14.7 %
Parking Area B:	
Impervious surface parking area:	972 square feet
Planting area at parking areas	130 square feet
Landscape Percentage	13.4 %
Parking Area C:	
Impervious surface parking area:	1,944 square feet
Planting area at parking areas	365 square feet
Landscape Percentage	18.7 %
Parking Area D:	
Impervious surface parking area:	18,434 square feet
Planting area at parking areas	3,256 square feet
Landscape Percentage	17.6 %
Parking Area E:	
Impervious surface parking area:	1,897 square feet
Planting area at parking areas	478 square feet
Landscape Percentage	25.2 %
Parking Area F:	
Impervious surface parking area:	14,710 square feet
Planting area at parking areas	3,289 square feet
Landscape Percentage	22.4 %





Harriman Project No. 16117

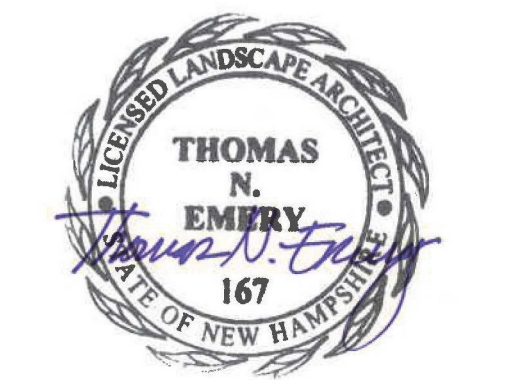

PERMIT DRAWINGS  
NOT FOR CONSTRUCTION

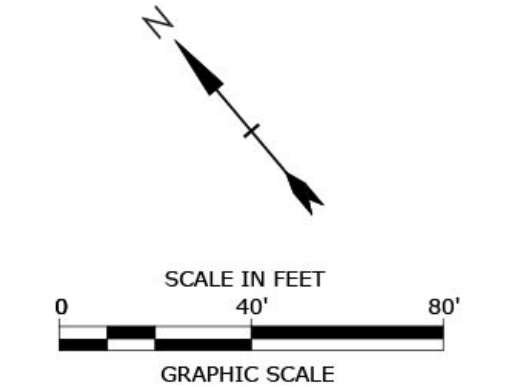

Mill Plaza  
Redevelopment

Colonial Durham  
Associates, LP

7 Mill Road, Unit L  
Durham,  
New Hampshire 03824

Landscape Schedule

Landscape Area Percentage to Parking Area Calculation

Impervious surface parking area:	96,122 square feet
Planting area at parking areas	16,065 square feet
Percentage	16.7 % (5% min. required)*

Note:  
\* = Per design standard Section 5.8 Parking Lots, Subsection 5.8.8

Parking Areas Breakdown:

Parking Area A:		
Impervious surface parking area:	58,165 square feet	
Planting area at parking areas	8,547 square feet	
Landscape Percentage	14.7 %	
Parking Area B:		
Impervious surface parking area:	972 square feet	
Planting area at parking areas	130 square feet	
Landscape Percentage	13.4 %	
Parking Area C:		
Impervious surface parking area:	1,944 square feet	
Planting area at parking areas	365 square feet	
Landscape Percentage	18.7 %	
Parking Area D:		
Impervious surface parking area:	18,434 square feet	
Planting area at parking areas	3,256 square feet	
Landscape Percentage	17.6 %	
Parking Area E:		
Impervious surface parking area:	1,897 square feet	
Planting area at parking areas	478 square feet	
Landscape Percentage	25.2 %	
Parking Area F:		
Impervious surface parking area:	14,710 square feet	
Planting area at parking areas	3,289 square feet	
Landscape Percentage	22.4 %	