

LINE	BEARING	DISTANCE
L1	S 12°39'20" W	53.33
L2	S 64°27'22" W	136.18
L3	S 62°13'22" W	12.12
L4	S 62°13'22" W	40.64
L5	S 62°13'22" W	35.16
L6	N 27°51'12" W	110.00
L7	N 42°05'08" W	120.09
L8	N 58°18'29" E	68.83
L9	N 58°18'29" E	53.81
L10	N 47°04'34" W	33.77
L11	N 63°58'54" W	104.61
L12	N 40°07'40" W	34.14
L13	S 63°58'54" E	104.61
L14	S 47°04'34" E	51.79

CURVE	RADIUS	ARC LENGTH	CHORD LENGTH	CHORD BEARING	DELTA ANGLE	TANGENT
C1	792.00'	179.16'	178.77'	S 19°08'09" W	12°57'38"	89.96'
C2	532.00'	303.89'	299.78'	S 41°58'51" W	32°43'44"	156.22'
C3	10.00'	19.08'	18.31'	N 07°34'24" E	109°17'57"	14.10'
C4	170.00'	50.16'	49.98'	N 55°31'44" W	16°54'20"	25.26'
C5	175.00'	49.75'	49.59'	N 55°50'13" W	16°17'23"	25.05'
C6	175.00'	98.16'	96.88'	S 31°37'22" E	32°08'19"	50.41'
C7	145.00'	128.15'	124.02'	S 22°22'22" E	50°38'19"	68.60'
C8	145.00'	41.22'	41.09'	S 55°50'13" E	16°17'23"	20.75'
C9	200.00'	59.01'	58.60'	S 55°31'44" E	16°54'20"	29.72'
C10	10.00'	11.95'	11.25'	S 81°18'36" E	68°28'03"	6.80'

I certify that this survey and plan was prepared by me or by those under my direct supervision. I certify that this survey was made on the ground and is correct to the best of my knowledge and belief. Random traverse survey by Theodolite and E.D.M. Precision greater than 1:15,000

L.L.S. #989
DATE

The certifications shown hereon are intended to meet registry of deed requirements and are not a certification to title or ownership of property shown. Owners of adjoining properties are according to current town assessors records.

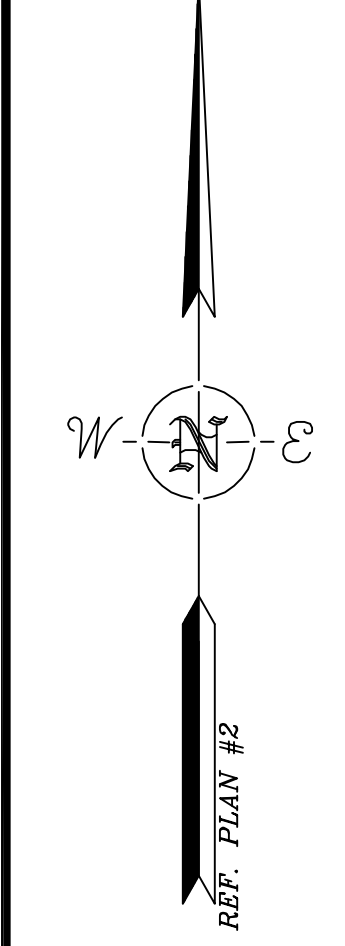

TAX MAP 6, LOT 8-2
JOEL TILLINGHAST
23 BRIMMER STREET #1
BOSTON, MA 02108
S.C.R.D. BOOK 3758, PAGE 629

TAX MAP 6, LOT 8-1
MURRY & DOROTHY STRAUS
33 MILL POND ROAD
DURHAM, NH 03824
S.C.R.D. BOOK 1940, PAGE 775

OYSTER RIVER
FRONTAGE=675±

TAX MAP 6, LOT 7-36
FRANK JR. & KATE E. POLITANO
39 MILL POND ROAD
DURHAM, NH 03824
S.C.R.D. BOOK 3835, PAGE 568

TAX MAP 6, LOT 7-10
DAVID A. & CYNTHIS S.
COOPER REV. TRUST
41 MILL POND ROAD
DURHAM, NH 03824
S.C.R.D. BOOK 3477, PAGE 534

1" "I" BAR FOUND,
LEANING NE

TAX MAP 6, LOT 9-11
COLIN WARE &
DIANNE E. RAMEY
10 LAUREL LANE
DURHAM, NH 03824
S.C.R.D. BOOK 3793, PAGE 760

TAX MAP 6, LOT 9-10
JEFFREY A. & CHRISTINA L. HILLER
6 LAUREL LANE
DURHAM, NH 03824
S.C.R.D. BOOK 3513, PAGE 122

TAX MAP 6, LOT 9-9
44 NEWMARKET ROAD, LLC
45 LAFAYETTE ROAD, SUITE 6
NORTH HAMPTON, NH 03862
S.C.R.D. BOOK 2869, PAGE 661

TAX MAP 6, LOT 11-4
HOLLY L. CRAIG
3 DURHAM POINT ROAD
DURHAM, NH 03824
S.C.R.D. BOOK 3816, PAGE 221

TAX MAP 6, LOT 12-4
LORI J. WILSON
2 DURHAM POINT ROAD
DURHAM, NH 03824
S.C.R.D. BOOK 2157, PAGE 677

TAX MAP 6, LOT 12-5
MARK & CHRISTINE HENDERSON
1 MAIN STREET, SUITE 16
DURHAM, NH 03824
S.C.R.D. BOOK 1806, PAGE 451

TAX MAP 6, LOT 12-6
WILLIAM SULLIVAN &
KAREN N. GERVASIO
181 DREW ROAD
MADBURY, NH 03823
S.C.R.D. BOOK 1806, PAGE 456

TAX MAP 6, LOT 12-8
WILLIAM & JANE LENHARTH
55 NEWMARKET ROAD
DURHAM, NH 03824

TAX MAP 6, LOT 12-7
REGAN ROBBINS
53 NEWMARKET ROAD
DURHAM, NH 03824
S.C.R.D. BOOK 4205, PAGE 219

TAX MAP 6, LOT 11-3
ARTHUR R.S. KLAESSON III
1 DURHAM POINT ROAD
DURHAM, NH 03824
S.C.R.D. BOOK 4229, PAGE 133

TAX MAP 6, LOT 11-7
GREAT BAY ANIMAL HOSPITAL, LLC
31 NEWMARKET ROAD
DURHAM, NH 03824
S.C.R.D. BOOK 4211, PAGE 10

EXISTING EXCLUSION AREA
317,180 sq. ft.
7.281 acres

PROPOSED EXCLUSION AREA
185,127 sq. ft.
4.250 acres

EXISTING LOT 9-8
747,463 sq. ft.
17.159 acres

PROPOSED LOT 9-8
615,410 sq. ft.
14.128 acres
(SEE NOTE #14)

PROPOSED LOT
132,053 sq. ft.
3.032 acres
ROUTE 108
FRONTAGE=239.95'

CONSERVATION
EASEMENT AREA
430,283 sq. ft.
9.878 acres
(SEE NOTES #14 & 17)
(SEE REF. PLAN #3)

EXISTING BUILDING
DECK
SHED
DECK

EXISTING BUILDING
EXISTING BUILDING

EXISTING BUILDING

DECK
SHED
DECK

EXISTING BUILDING
EXISTING BUILDING

EXISTING BUILDING

EXISTING BUILDING
DECK
SHED
DECK

EXISTING BUILDING
EXISTING BUILDING

EXISTING BUILDING

EXISTING BUILDING
DECK
SHED
DECK

EXISTING BUILDING
EXISTING BUILDING

EXISTING BUILDING

EXISTING BUILDING
DECK
SHED
DECK

EXISTING BUILDING
EXISTING BUILDING

EXISTING BUILDING

EXISTING BUILDING
DECK
SHED
DECK

EXISTING BUILDING
EXISTING BUILDING

EXISTING BUILDING

EXISTING BUILDING
DECK
SHED
DECK

EXISTING BUILDING
EXISTING BUILDING

EXISTING BUILDING

- LEGEND
- UTILITY POLE & GUY WIRE
 - DRILL HOLE FOUND
 - IRON PIPE/ROD FOUND
 - 5/8" RE-BAR W/ ID CAP TO BE SET
 - TYP. TYPICAL
 - RET. RETAINING
 - EP EDGE OF PAVEMENT
 - EOG EDGE OF GRAVEL
 - OH OVERHANG
 - BEARING PROPERTY LINES
 - DIST BEARING PROPOSED PROPERTY LINES
 - SETBACK LINE
 - WOOD RAIL FENCE
 - SINGLE CHAIN FENCE
 - OHW OVERHEAD WIRES
 - APPROX. ABUTTERS LOT LINE
 - EASEMENT LINES
 - STONE WALL
 - WETLAND LINE (SEE NOTE #6)

PROPOSED ACCESS & UTILITY EASEMENT
(SEE NOTES #13 & #20)

1" "I" BAR FOUND,
UP 7" W/ CAP.
G.L. DAVIS ENGINEERING
DOVER, NH

STONE RET. WALL

EXTENTS OF DRIVEWAY IMPROVEMENTS

ELECTRIC LINE TO BE REMOVED
(SEE NOTE #16)

MAG NAIL SET @ INTERSECTION STONE WALL

DRILL HOLE SET @ CL @ STONE WALL

GRANITE BOUND FOUND

IRON ROD FOUND

STONE WALL EASEMENT
(SEE NOTE #14)

STONE RET. WALL

EXTENTS OF DRIVEWAY IMPROVEMENTS

ELECTRIC LINE TO BE REMOVED
(SEE NOTE #16)

MAG NAIL SET @ INTERSECTION STONE WALL

DRILL HOLE SET @ CL @ STONE WALL

GRANITE BOUND FOUND

IRON ROD FOUND

STONE WALL EASEMENT
(SEE NOTE #14)

STONE RET. WALL

EXTENTS OF DRIVEWAY IMPROVEMENTS

ELECTRIC LINE TO BE REMOVED
(SEE NOTE #16)

MAG NAIL SET @ INTERSECTION STONE WALL

DRILL HOLE SET @ CL @ STONE WALL

GRANITE BOUND FOUND

IRON ROD FOUND

STONE WALL EASEMENT
(SEE NOTE #14)

STONE RET. WALL

EXTENTS OF DRIVEWAY IMPROVEMENTS

ELECTRIC LINE TO BE REMOVED
(SEE NOTE #16)

MAG NAIL SET @ INTERSECTION STONE WALL

DRILL HOLE SET @ CL @ STONE WALL

GRANITE BOUND FOUND

IRON ROD FOUND

STONE WALL EASEMENT
(SEE NOTE #14)

STONE RET. WALL

EXTENTS OF DRIVEWAY IMPROVEMENTS

ELECTRIC LINE TO BE REMOVED
(SEE NOTE #16)

MAG NAIL SET @ INTERSECTION STONE WALL

DRILL HOLE SET @ CL @ STONE WALL

GRANITE BOUND FOUND

IRON ROD FOUND

STONE WALL EASEMENT
(SEE NOTE #14)

STONE RET. WALL

EXTENTS OF DRIVEWAY IMPROVEMENTS

ELECTRIC LINE TO BE REMOVED
(SEE NOTE #16)

MAG NAIL SET @ INTERSECTION STONE WALL

DRILL HOLE SET @ CL @ STONE WALL

GRANITE BOUND FOUND

IRON ROD FOUND

STONE WALL EASEMENT
(SEE NOTE #14)

STONE RET. WALL

EXTENTS OF DRIVEWAY IMPROVEMENTS

ELECTRIC LINE TO BE REMOVED
(SEE NOTE #16)

MAG NAIL SET @ INTERSECTION STONE WALL

DRILL HOLE SET @ CL @ STONE WALL

GRANITE BOUND FOUND

IRON ROD FOUND

STONE WALL EASEMENT
(SEE NOTE #14)

STONE RET. WALL

EXTENTS OF DRIVEWAY IMPROVEMENTS

ELECTRIC LINE TO BE REMOVED
(SEE NOTE #16)

MAG NAIL SET @ INTERSECTION STONE WALL

DRILL HOLE SET @ CL @ STONE WALL

GRANITE BOUND FOUND

IRON ROD FOUND

STONE WALL EASEMENT
(SEE NOTE #14)

FINAL APPROVAL BY DURHAM PLANNING BOARD.
CERTIFIED BY MICHAEL BEHRENDT, TOWN PLANNER

DATE

SUBDIVISION PLAN
LAND OF
SEACOAST REPERTORY THEATRE
(TAX MAP 6, LOT 9-8)
50 NEWMARKET ROAD
DURHAM, NEW HAMPSHIRE

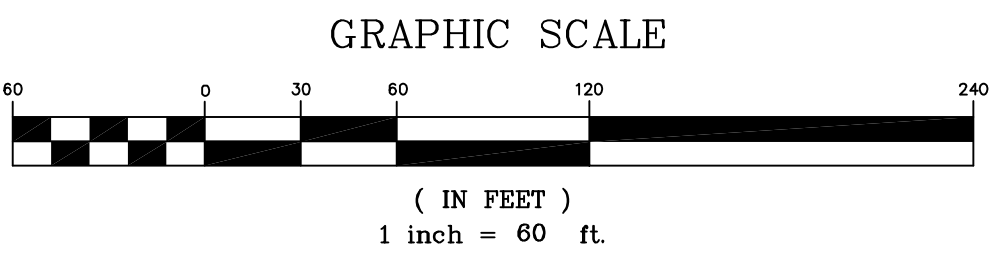

DRAWN BY: M.W.F. DATE: FEB. 25, 2015

CHECKED BY: W.J.D. DRAWING NO.: 3978A

JOB NO.: 3978 SHEET 1 OF 3



NO.	DATE	DESCRIPTION	BY
1	3/23/15	PLANNERS RECOMMENDATIONS	MWF

NOTE:
ALL ELECTRIC, GAS, TEL, WATER, SEWER AND DRAIN SERVICES ARE SHOWN IN SCHEMATIC FASHION. THEIR LOCATIONS ARE NOT PRECISE OR NECESSARILY ACCURATE. NO WORK WHATSOEVER SHALL BE UNDERTAKEN ON THIS SITE USING THIS PLAN TO LOCATE THE ABOVE SERVICES. CONSULT WITH THE PROPER AUTHORITIES CONCERNED WITH THE SUBJECT SERVICE LOCATIONS FOR INFORMATION REGARDING SUCH. CALL DIG-SAFE AT 1-888-DIG-SAFE.

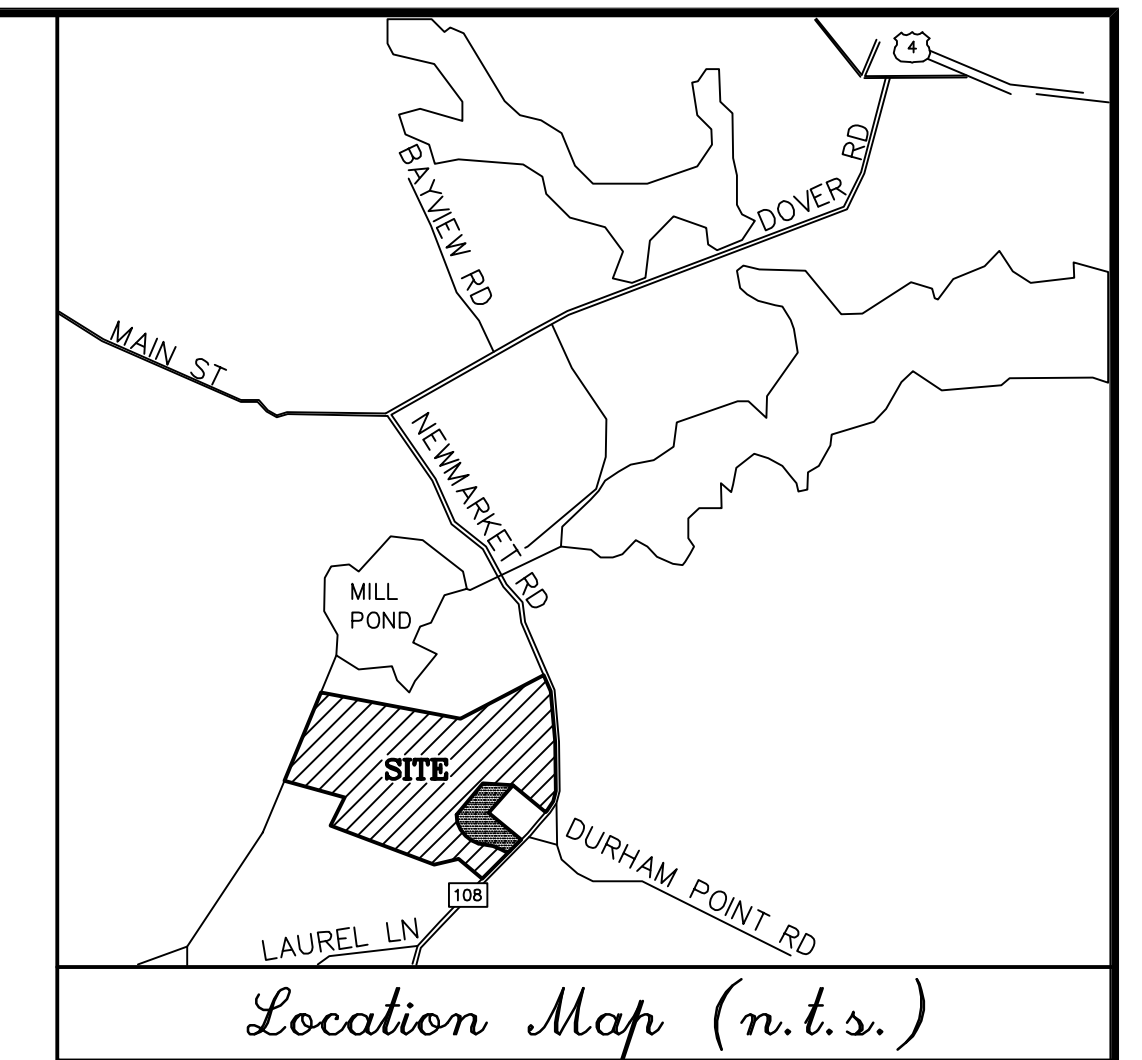

NOTES:

1. REFERENCE: TAX MAP 6, LOT 9-8
2. TOTAL PARCEL AREA: 747,463 SQ. FT. OR 17.159 AC.
(SEE NOTE #14)
3. OWNER OF RECORD: TAX MAP 6, LOT 9-8 SEACOAST REPERTORY THEATRE 125 BOW STREET PORTSMOUTH, NH 03801 S.C.R.D. BOOK 3992, PAGE 997
 APPLICANT: HELEN GORANSSON 255 DEPOT ROAD ELIOT, ME 03903-1276
4. ZONE: RB (RESIDENCE B) DIMENSIONAL REQUIREMENTS:

MIN. LOT AREA	40,000 sq.ft.
MIN. FRONTAGE	150 ft.
MIN. FRONT SETBACK	40 ft.
MIN. REAR SETBACK	30 ft.
MIN. SIDE SETBACK	20 ft.
HIGH WATER	150 ft.

 WETLAND CONSERVATION DISTRICT SETBACK REQUIREMENTS
 STRUCTURES-POORLY DRAINED 50 ft.
 VERY POORLY DRAINED 75 ft.
 SEPTIC-75 ft.
 SHORELAND SETBACK REQUIREMENTS
 STRUCTURES-75 ft.
 SEPTIC-150 ft.
 THIS PLAN CONFORMS TO ALL APPLICABLE LOCAL ZONING ORDINANCES AND RULES.
5. FIELD SURVEY PERFORMED BY S.D.B. & N.J.L. DURING 01/03 USING A LEICA 705 TCR TOTAL STATION WITH A TDS RANGER DATA COLLECTOR AND A SOKKIA B21 AUTO LEVEL. TRAVERSE ADJUSTMENT BASED ON LEAST SQUARE ANALYSIS.
6. JURISDICTIONAL WETLANDS DELINEATED BY NH SOIL CONSULTANTS, INC. DURING JANUARY 2003 IN ACCORDANCE WITH 1987 CORPS OF ENGINEERS WETLANDS DELINEATIONS MANUAL, TECHNICAL REPORT Y-87-1.
7. FLOOD HAZARD ZONE: "X" & "AE", PER FIRM MAP #33017C03180, DATED 5/17/05.
8. HORIZONTAL DATUM BASED ON REFERENCE PLAN #2.
9. VERTICAL DATUM IS BASED ON DISK 133 0090 ELEV. 64.38' (NGVD29).
10. THE INTENT OF THIS PLAN IS TO SHOW THE LOCATION OF BOUNDARIES IN ACCORDANCE WITH AND IN RELATION TO THE CURRENT LEGAL DESCRIPTION, AND IS NOT AN ATTEMPT TO DEFINE UNWRITTEN RIGHTS, DETERMINE THE EXTENT OF OWNERSHIP, OR DEFINE THE LIMITS OF TITLE.
11. FINAL MONUMENTATION MAY BE DIFFERENT THAN THE PROPOSED MONUMENTATION SHOWN HEREON, DUE TO THE FACT THAT SITE CONDITIONS WILL DICTATE THE ACTUAL LOCATION AND TYPE OF MONUMENTS INSTALLED IN THE FIELD. PLEASE REFER TO EITHER THE "MONUMENTATION LOCATION PLAN" TO BE RECORDED OR CONTACT DOUCET SURVEY, INC. FOR CLARIFICATION OF MONUMENTS SET. (A RECORDED PLAN WILL BE PRODUCED AT THE DISCRETION OF DOUCET SURVEY, INC.).

12. WATER BOUNDARIES ARE DYNAMIC IN NATURE AND ARE SUBJECT TO CHANGE DUE TO NATURAL CAUSES SUCH AS EROSION OR ACCRETION. AREA SHOWN HEREON CALCULATED TO THREAD OF OYSTER RIVER.
13. PROPOSED ACCESS & UTILITY EASEMENT IN FAVOR OF LOT 9-8 AS SHOWN IS 30' WIDE AND 389.07' FEET IN LENGTH. THE EASEMENT ALLOWS FOR A POTENTIAL BROAD RANGE OF USES ON THE REAR LOT. THE TERMS OF THE EASEMENT, AS APPROVED AND AS RECORDED HEREIN MAY NOT BE CHANGED WITHOUT THE EXPRESS APPROVAL OF THE DURHAM PLANNING BOARD.
14. ROUTE 108 WIDENING
 -SEE EASEMENT RELEASE S.C.R.D. BOOK 4255, PAGE 897.
 -EXTENTS OF ROUTE 108 WIDENING PER S.C.R.D. BOOK 4255, PAGE 899 AND REFERENCE PLAN #4.
 -STONEWALL EASEMENT SEE S.C.R.D. BOOK 4255, PAGE 897.
15. STATE APPROVALS
 -NHDES STATE SUBDIVISION APPROVAL #SA2015033102, DATED 3/31/15.
 -NHDOT DRIVEWAY PERMIT #PENDING.
16. OVERHEAD ELECTRIC LINE TO BE REROUTED ALONG EXISTING DRIVEWAY TO HOUSE PER WAIVER REQUEST TO TOWN OF DURHAM SUBDIVISION REGULATIONS SECTION 9.05(B). THE PROPOSED LOCATION OF RELOCATED POLES AND WIRES TO BE DETERMINED BY THE UTILITY COMPANIES AT TIME OF WORK.
17. TAX MAP 6, LOT 9-8 IS SUBJECT TO A CONSERVATION EASEMENT (SEE S.C.R.D. BOOK 3123, PAGE 170).
- 18*. THE DURHAM HISTORIC DISTRICT COMMISSION (HDC) HAS PURVIEW OVER ANY CHANGES TO THE BUILDINGS, STRUCTURES, STONEWALLS, CELLAR WALLS, FENCES, DRIVEWAYS AND PAVEMENT, REMOVAL OF TREES WITH A 12" DIAMETER, AND SUBSTANTIAL CHANGES IN TOPOGRAPHY WITHIN THE HISTORIC DISTRICT (AS IDENTIFIED ON THE PLAN). INTERESTED PARTIES ARE ENCOURAGED TO COORDINATE WITH THE HDC AS EARLY AS POSSIBLE.
19. FOR MORE INFORMATION ABOUT THIS SUBDIVISION, OR TO SEE THE COMPLETE PLAN SET, CONTACT THE TOWN OF DURHAM PLANNING DEPARTMENT, 15 NEWMARKET ROAD, DURHAM, NH 03824, (603) 868-8064.
20. THE SHARED DRIVEWAY ACCESSED OFF NEWMARKET ROAD/ROUTE 108 IS A PRIVATE SHARED DRIVEWAY AND IS NOT MAINTAINED BY THE TOWN OF DURHAM, NOR DOES THE TOWN COLLECT GARBAGE ALONG THIS SHARED DRIVEWAY. IT IS THE RESPONSIBILITY OF THE OWNERS OF THE 2 LOTS INCLUDED IN THIS SUBDIVISION TO MAINTAIN THE SHARED DRIVEWAY AS SPECIFIED IN THE ACCESS AND MAINTENANCE DOCUMENTS.
21. INTERESTED PARTIES ARE ENCOURAGED TO CONTACT THE DURHAM BUILDING AND FIRE DEPARTMENT REGARDING THE STATUS OF THE HOUSE AND BARN ON THE REAR LOT.
22. THE LOCATION OF THE DRIVEWAY LEADING INTO THE FRONT LOT IS THE APPROVED LOCATION. THE DRIVEWAY SHALL BE LOCATED AS SHOWN UNLESS AN ALTERNATIVE ACCEPTABLE LOCATION IS APPROVED BY THE DEPARTMENT OF PUBLIC WORKS.
23. THE BUYER OF THE NEW FRONT LOT IS RESPONSIBLE FOR CONSTRUCTION IMPROVEMENTS TO THE SHARED DRIVEWAY. THE DRIVEWAY SHALL BE SATISFACTORILY COMPLETE PRIOR TO ISSUANCE OF A CERTIFICATE OF OCCUPANCY FOR ANY BUILDING ON THE FRONT LOT. AN APPROPRIATE SURETY SHALL BE PLACED WITH THE TOWN PRIOR TO ISSUANCE OF A BUILDING PERMIT.
- 24*. SEVERAL VARIANCES AND SITE PLAN APPROVALS HAVE BEEN GRANTED FOR THE REAR LOT. ONE OR MORE OF THESE APPROVALS MAY OR MAY NOT STILL BE VALID. ANY PARTY INTERESTED IN CONTINUING THESE USES IS URGED TO CONSULT WITH THE TOWN OF DURHAM ZONING ADMINISTRATOR FOR CLARIFICATION.

REFERENCE PLANS:

1. "ESTATE OF MILICENT C. CHAMBERLIN DURHAM, NH" DATED AUGUST 1955, BY G.L. DAVIS & ASSOC., S.C.R.D. PLAN #4, POCKET #7, FOLDER #5.
2. "PLAN OF LOTS JAMES C. & NELL E. CHAMBERLIN NEWMARKET ROAD DURHAM, NH", DATED JANUARY 1980, BY G.L. DAVIS & ASSOC., S.C.R.D. PLAN #20-147".
3. "CONSERVATION EASEMENT PLAN FOR MILL POND CENTER", BY DOUCET SURVEY, INC., DATED MARCH 5, 2003, S.C.R.D. PLAN #78-31.
4. "NH ROUTE 108 RIGHT-OF-WAY GEOMETRIC LAYOUT PLAN, STATE PROJECT #13080", SHEETS #14 & 26-27, DATED 3/14, ON FILE AT THE NHDOT DISTRICT 6 OFFICE.

AREA CALCULATIONS (PER ZONING ORD. 175-64)
 TOTAL PROPOSED PARCEL AREA=115,465 SQ. FT.
 POORLY DRAINED SOILS=6,531 SQ. FT. (-)
 RESIDUAL LOT AREA=108,934 SQ. FT.

NO.	DATE	DESCRIPTION	BY
1	3/23/15	PLANNERS RECOMMENDATIONS	WJF

NOTE:
 ALL ELECTRIC, GAS, TEL, WATER, SEWER AND DRAIN SERVICES ARE SHOWN IN SCHEMATIC FASHION. THEIR LOCATIONS ARE NOT PRECISE OR NECESSARILY ACCURATE. NO WORK WHATSOEVER SHALL BE UNDERTAKEN ON THIS SITE USING THIS PLAN TO LOCATE THE ABOVE SERVICES. CONSULT WITH THE PROPER AUTHORITIES CONCERNED WITH THE SUBJECT SERVICE LOCATIONS FOR INFORMATION REGARDING SUCH. CALL DIG-SAFE AT 1-888-DIG-SAFE.

I certify that this survey and plan was prepared by me or by those under my direct supervision. I certify that this survey was made on the ground and is correct to the best of my knowledge and belief. Random traverse survey by theodolite and E.D.M. Precision greater than 1:15,000

L.L.S. #989
 DATE _____
 The certifications shown herein are intended to meet registry of deed requirements and are not a certification of title or ownership of property shown. Owners of adjoining properties are according to current town assessors records.

FINAL APPROVAL BY DURHAM PLANNING BOARD.
 CERTIFIED BY MICHAEL BEHRENDT, TOWN PLANNER
 _____ DATE _____

DRAWN BY:	M.W.F.	DATE:	FEB. 25, 2015
CHECKED BY:	W.J.D.	DRAWING NO.:	3978A
JOB NO.:	3978	SHEET	2 OF 3

DOUCET SURVEY
 Serving Your Professional Surveying & Mapping Needs
 102 Kent Place, Newmarket, NH 03857 (603) 858-6560
 10 Steiner Street (RiverView Suite) Kennebunk, ME (207) 502-7005
<http://www.doucetsurvey.com>

AREA CALCULATIONS (PER ZONING ORD. 175-64)
 TOTAL PROPOSED PARCEL AREA=115,485 SQ. FT.
 POORLY DRAINED SOILS=6,531 SQ. FT. (-)
 RESIDUAL LOT AREA=108,954 SQ. FT.

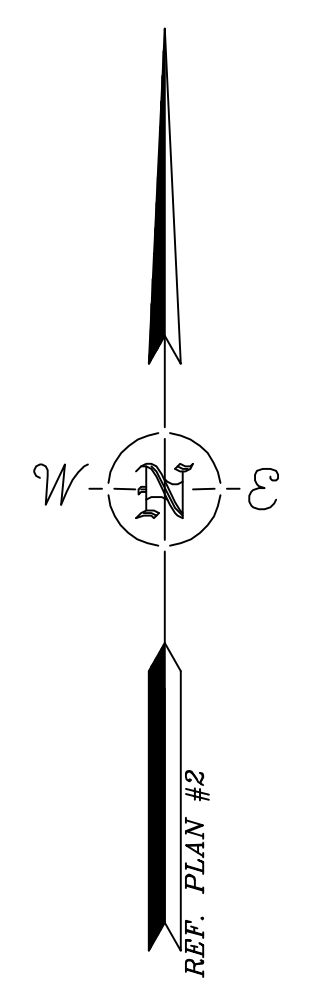

OYSTER RIVER
 FRONTAGE=675±

FLOOD LINE
 (SEE NOTE #7)

- LEGEND**
- UTILITY POLE & GUY WIRE
 - CATCH BASIN
 - CONIFEROUS TREE
 - DECIDUOUS TREE
 - TEST PIT
 - TYP. RET.
 - EP
 - EOG
 - OH
 - PROPERTY LINES
 - PROPOSED PROPERTY LINES
 - SETBACK LINE
 - WOOD RAIL FENCE
 - SINGLE CHAIN FENCE
 - OHW
 - APPROX. ABUTTERS LOT LINE
 - EASEMENT LINES
 - STONE WALL
 - DRAIN LINE
 - CONTOUR LINE
 - WETLAND LINE
 - HISS LINE
 - HISS TYPE
 - PROPOSED BUILDING
 - PROPOSED SEPTIC
 - PROPOSED WELL



FINAL APPROVAL BY DURHAM PLANNING BOARD.
 CERTIFIED BY MICHAEL BEHRENDT, TOWN PLANNER
 _____ DATE _____

NO.	DATE	DESCRIPTION	BY

NOTE:
 ALL ELECTRIC, GAS, TEL, WATER, SEWER AND DRAIN SERVICES ARE SHOWN IN SCHEMATIC FASHION. THEIR LOCATIONS ARE NOT PRECISE OR NECESSARILY ACCURATE. NO WORK WHATSOEVER SHALL BE UNDERTAKEN ON THIS SITE USING THIS PLAN TO LOCATE THE ABOVE SERVICES. CONSULT WITH THE PROPER AUTHORITIES CONCERNED WITH THE SUBJECT SERVICE LOCATIONS FOR INFORMATION REGARDING SUCH. CALL DIG-SAFE AT 1-888-DIG-SAFE.

I certify that this survey and plan was prepared by me or by those under my direct supervision. I certify that this survey was made on the ground and is correct to the best of my knowledge and belief. Random traverse survey by theodolite and E.D.M. Precision greater than 1:15,000

 L.L.S. #989
 DATE _____

The certifications shown hereon are intended to meet registry of deed requirements and are not a certification to title or ownership of property shown. Owners of adjoining properties are according to current town assessors records.

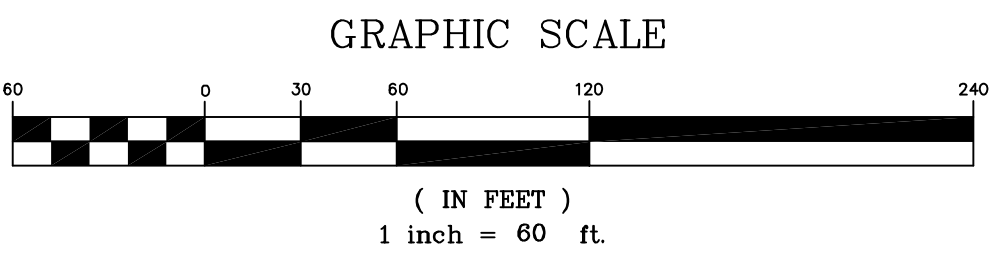

DRAWN BY:	M.W.F.	DATE:	FEB. 25, 2015
CHECKED BY:	W.J.D.	DRAWING NO.:	3978A
JOB NO.:	3978	SHEET	3 OF 3

DOUCET SURVEY
 Serving Your Professional Surveying & Mapping Needs
 102 Kent Place, Newmarket, NH 03857 (603) 658-6560
 10 Steiner Street (RiverView Suite) Kennebunk, ME (207) 502-7005
<http://www.doucetsurvey.com>

TOPOGRAPHIC PLAN PLAN
 LAND OF
 SEACOAST REPERTORY THEATRE
 (TAX MAP 6, LOT 9-8)
 50 NEWMARKET ROAD
 DURHAM, NEW HAMPSHIRE