



**PLANNING DEPARTMENT**

**Town of Durham**

8 Newmarket Road

Durham, NH 03824-2898

Phone (603) 868-8064

[www.ci.durham.nh.us](http://www.ci.durham.nh.us)

**Modification to Approved Project**

**Durham, New Hampshire**

Project name 12 Jenkins Ct.

Property Address 12 Jenkins Ct Map and Lot # 4-9

Type of project: Site Plan ☒; Subdivision ☐; Lot Line Adjustment ☐; Other ☐

Date of original Planning Board approval April 2009

Description of modification Create accessible way where steps were previously located, move trash location

Reason for modification need ADA >50% Rule

Name of applicant or agent filling out this form Thomas Christie president

Applicant? ☒ Agent? ☐ Today's date 1/7/2016 Slama Enterprises Inc

**Please note:** Modifications are reviewed by the Planning Board. They are not considered to have significant impact upon abutters or the general public so no notification nor public hearing is required. Note, however, then when a modification is presented to the board, the board may require notification and a public hearing where it determines that the request should be treated as an amendment. The applicant must submit any supplementary materials necessary to explain and support the modification, such as a narrative and plans.

----- Office use below -----

Amendment approved ☐ Amendment denied ☐ Date of Planning Board action ☐

Conditions ☐

Signature: ☐ Date: ☐

# Plot Plan

## Instructions:

- 1) Show the Property lines and road(s).
- 2) Show the proposed Structure and all existing structures.
- 3) Show the Measurements from the proposed structure to all lot lines, wetlands and/or shorelands. Measure straight through existing structures if needed.
- 4) Include the dimensions of the proposed structure.

See Zoning Dimensional Table for setbacks.

## Sample Plan:

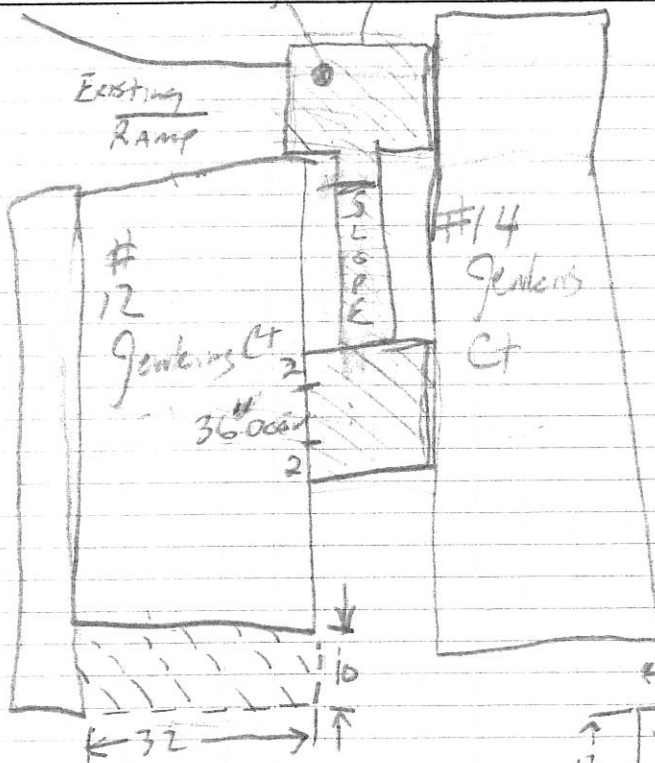
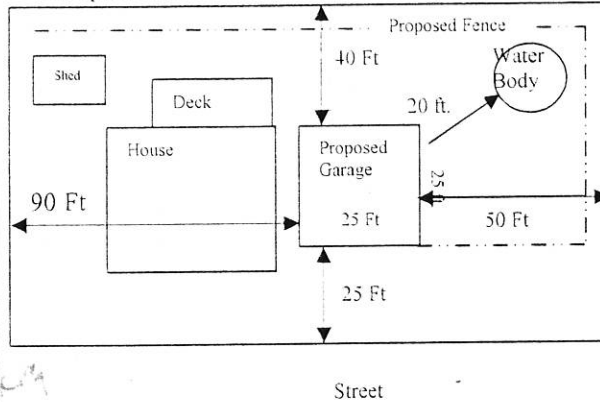

Previously proposed addition to be BUILT 10x32 FT

ADD TREX OR SIMILAR ADA Compliant Ramp/Platform For Access to 36" side door of Jenkins Ct #12.

## Structural Design

- 1) 8" "SLOPE" Base  $\frac{1}{8}$  Below grade
- 2) Ledger BOARD support  $\frac{1}{2}$  anchors to BUILDING
- 3) ALL MATERIAL - pressure treated For structure
- 4) Decking Trex

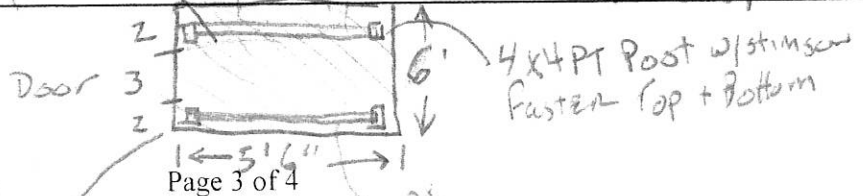
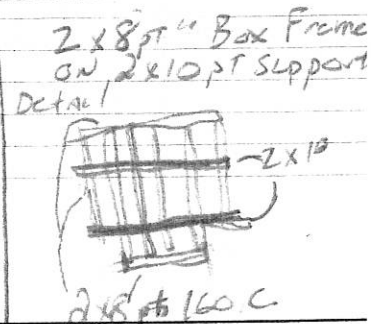
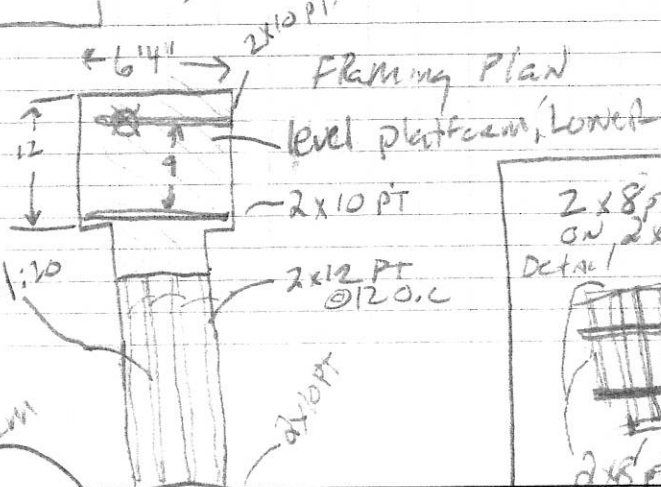

This end of Rail Ballistics