

C-1 CONSTRUCTION NOTES:

- THE CONTRACTOR IS REQUIRED UNDER NEW HAMPSHIRE LAW TO CONTACT "DIG SAFE" AT 1-888-344-7233, 72 HOURS PRIOR TO THE START OF CONSTRUCTION. THE CONTRACTOR SHALL MAINTAIN THE "DIG SAFE" LOCATIONS THROUGH OUT THE DURATION OF THE PROJECT.
- THE CONTRACTOR SHALL BEAR THE COST TO REPAIR ANY UTILITIES DAMAGED DURING THE COURSE OF THE WORK.
- EXISTING UTILITIES - ALL INFORMATION ON, AND LOCATION OF, EXISTING UTILITIES ARE APPROXIMATE AND BASED ON FIELD INFORMATION AND AVAILABLE PLANS. EXACT LOCATIONS AND DEPTHS TO BE VERIFIED BY THE CONTRACTOR PRIOR TO CONSTRUCTION.
- ALL CONSTRUCTION SHALL CONFORM WITH THE 2006 STATE OF NEW HAMPSHIRE DEPARTMENT OF TRANSPORTATION (NHDOT) "STANDARD SPECIFICATIONS FOR ROAD AND BRIDGE CONSTRUCTION"; HEREINAFTER REFERRED TO AS THE "STANDARD SPECIFICATIONS" AND ALSO WITH THE "TOWN OF DURHAM SPECIFICATIONS".
- INSTALL HANDICAP PARKING SIGNS (4).
- INSTALL HANDICAP ACCESSIBLE REINFORCED CONCRETE RAMP (MAXIMUM SLOPE = 1" IN 12") FROM PAVEMENT GRADE TO SIDEWALK GRADE IN COMPLIANCE WITH ALL A.D.A. STANDARDS.
- YELLOW OR WHITE PAVEMENT MARKINGS.
- INSTALL TEMPORARY SILT FENCE PRIOR TO ANY EARTHWORK ACTIVITIES PER DETAIL 2, SHEET SP-6. STILL FENCE SHALL BE ORANGE.
- ALL DISTURBED AREAS SHALL BE PROTECTED FROM EROSION AND SEDIMENTATION BY THE IMPLEMENTATION OF THE EROSION AND SEDIMENT CONTROL PRACTICES WHICH ARE GIVEN IN DETAIL 11, SHEET SP-6.
- INSTALL CONDUIT FOR UNDERGROUND UTILITIES, CABLE INSTALLED BY OTHERS. COORDINATE LOCATION & SIZE WITH INDIVIDUAL UTILITY.
- INSTALL CONCRETE POLE BASE AND LIGHTS WHERE SHOWN PER DETAIL 11, SHEET SP-5. ALL LIGHTING SHALL BE SHIELDED, CUT-OFF TYPE FIXTURES.
- INSTALL BUILDING MOUNTED LIGHTS AS INDICATED ON SHEET SP-2. ALL FIXTURES SHALL BE SHIELDED, CUT-OFF TYPE FIXTURES.
- INSTALL CAPE COD BERM PER DETAIL 5, SHEET SP-5.
- INSTALL 8"x16" REINFORCED CONCRETE DUMPSTER PAD WITH 6' HIGH CHAIN LINK FENCE WITH GATE.
- INSTALL BITUMINOUS CONCRETE WALK PER DETAIL 12, SHEET SP-5.
- AS-BUILT PLANS OF THE SITE SHALL BE SUBMITTED ON A REPRODUCIBLE MYLAR MEDIUM AND IN A DIGITAL DXF FORMAT TO THE TOWN OF DURHAM ENGINEER'S OFFICE UPON COMPLETION OF THE PROJECT. AS-BUILTS SHALL BE PREPARED AND CERTIFIED CORRECT BY A LICENSED LAND SURVEYOR OR PROFESSIONAL ENGINEER.
- INSTALL SIDEWALK TIP-DOWN.
- BEGIN SLOPED GRANITE CURB.
- INSTALL SLOPED GRANITE CURB PER DETAIL 4, SHEET SP-5.
- END SLOPED GRANITE CURB, BEGIN CAPE COD BERM.
- MATCH EXISTING PAVEMENT.
- INSTALL INTEGRATED CURB AND CONCRETE SIDEWALK PER DETAIL 7, SHEET SP-5.
- COORDINATE INSTALLATION OF UTILITY POLE WITH APPROPRIATE UTILITY.
- INSTALL 55' OF 6' HIGH VINYL FENCE.
- INSTALL SEGMENTED BLOCK RETAINING WALL. SHOP DRAWINGS TO BE PROVIDED TO THE TOWN ENGINEER PRIOR TO CONSTRUCTION. TOP = 102.80, BOT = 100.00.
- PROVIDE TIMBER FRAME GUARD RAIL. SEE DETAIL 10, SHEET SP-9.
- INSTALL STABILIZED CONSTRUCTION ENTRANCE PER DETAIL 2, SHEET SP-9.

D-1 DRAINAGE NOTES:

- INSTALL LEVEL SPREADER PER DETAIL 12, SHEET SP-6.
- INSTALL RIPRAP PER DETAIL 6, SHEET SP-9.
W1 = 3', W0 = 12', d = 7", L0 = 9', D50 = 3".
- INSTALL P-205, 37' - 12" HDPE FROM CB 105 TO FES 002.
S = 0.0100 FT/FT, INVin = 97.35, INVout = 97.15.
- INSTALL DETENTION BASIN PER DETAIL 9, SHEET SP-6. PLANTINGS SHALL CONFORM TO PLANT LIST RECOMMENDATIONS PROVIDED BY WOODBURN AND ASSOCIATES AND DEPICTED ON SHEET SP-10.
- INSTALL FES 002, INVin = 97.35.
- INSTALL P-201, 71' - 12" HDPE FROM DMH 301 TO FES 001.
S = 0.0050, INVin = 97.70, INVout = 97.35.
- INSTALL P-202, 92' - 12" HDPE FROM CB 102 TO DMH 301.
S = 0.0050, INVin = 98.25, INVout = 97.80.
- INSTALL P-204, 38' - 12" HDPE FROM CB 104 TO DMH 301.
S = 0.0500, INVin = 98.00, INVout = 97.50.
- INSTALL P-208, 20' - 12" HDPE FROM CB 101 TO CB 102.
S = 0.0500, INVin = 98.35, INVout = 98.25.
- INSTALL P-203, 27' - 12" HDPE FROM CB 103 TO CB 102.
S = 0.0500, INVin = 98.50, INVout = 98.35.
- INSTALL ROOF INFILTRATION SYSTEM: 80' - 8" PERFORATED HDPE SET LEVEL, PER DETAIL 9, SHEET SP-5.
- INSTALL P-207, 92' - 8" HDPE FROM YD 107 TO INFILTRATION SYSTEM.
S = 0.0100, INVin = 102.35, INVout = 101.80.
- INSTALL P-208, 160' - 8" HDPE.
S = 0.0200, INVin = 102.35, INVout = 98.60.
- INSTALL P-209, 95' - 8" HDPE FROM YD 105 TO P-207.
S = 0.0100, INVin = 103.30, INVout = 102.35.
- INSTALL P-210, 45' - 8" HDPE FROM YD 108 TO YD 107.
S = 0.0200, INVin = 103.25, INVout = 102.35.
- SEE STORMWATER MANAGEMENT PLAN. RAKE, LOAM AND SEED ANNUALLY TO PREVENT EROSION.
- INSTALL 10' WIDE BY 4' LONG EMERGENCY OVERFLOW.
INSTALL 10' WIDE BY 20' LONG BY 16" THICK RIPRAP. D50 = 7".
- INSTALL TEMPORARY EROSION BARRIER AROUND ALL CATCH BASINS PER DETAIL 1, SHEET SP-9.
- INSTALL STONE CHECK DAM PER DETAIL 9, SHEET SP-9.
- INSTALL RIPRAP PER DETAIL 6, SHEET SP-9.
W1 = 3', W0 = 16', d = 14", L0 = 13', D50 = 6".
- INSTALL STAND PIPE WITH OBSERVATION WELL AND INFILTRATION OUTLET PER DETAIL 9, SHEET SP-5. OUTLET LENGTH = 23".
INVin = 101.97, INVout = 101.5, S = 0.0204 FT/FT.
- INSTALL 10' LONG 4' WIDE RIPRAP. D50 = 7", DEPTH = 16".

S-1 SEWER NOTES:

- EXISTING SEWER - ALL INFORMATION ON, AND LOCATION OF, EXISTING UTILITIES ARE APPROXIMATE AND BASED ON FIELD INFORMATION AND AVAILABLE PLANS. EXACT LOCATIONS AND DEPTHS TO BE VERIFIED BY THE CONTRACTOR PRIOR TO CONSTRUCTION. MAINTAIN CONTINUOUS SEWER FLOW DURING CONSTRUCTION.
- INSTALL 95' - 8" SDR35 PVC FROM BUILDING TO SMH #1.
INVin = 99.23, INVout = 98.85, S = 0.0040 FT/FT
- INSTALL 290' - 8" SDR35 PVC FROM SMH #1 TO SMH #2. Z W
INVin = 98.75, INVout = 96.60, S = 0.0075 FT/FT
- INSTALL 300' - 8" SDR35 PVC FROM SMH #2 TO SMH #3.
INVin = 96.50, INVout = 91.94, S = 0.0152 FT/FT
- INSTALL 252' - 8" SDR35 PVC FROM SMH #3 TO SMH #4.
INVin = 91.84, INVout = 89.45, S = 0.0095 FT/FT.
- INSTALL 13' - 8" SDR35 PVC FROM SMH #4 TO EX SMH.
INVin = 84.00, INVout = 82.94, S = 0.0100 FT/FT
- INSTALL OUTSIDE DROP AS SHOWN ON SHEET SP-8.
- CORE AND BOOT EXISTING SMH FOR 8" TO ALLOW FOR CLEANING

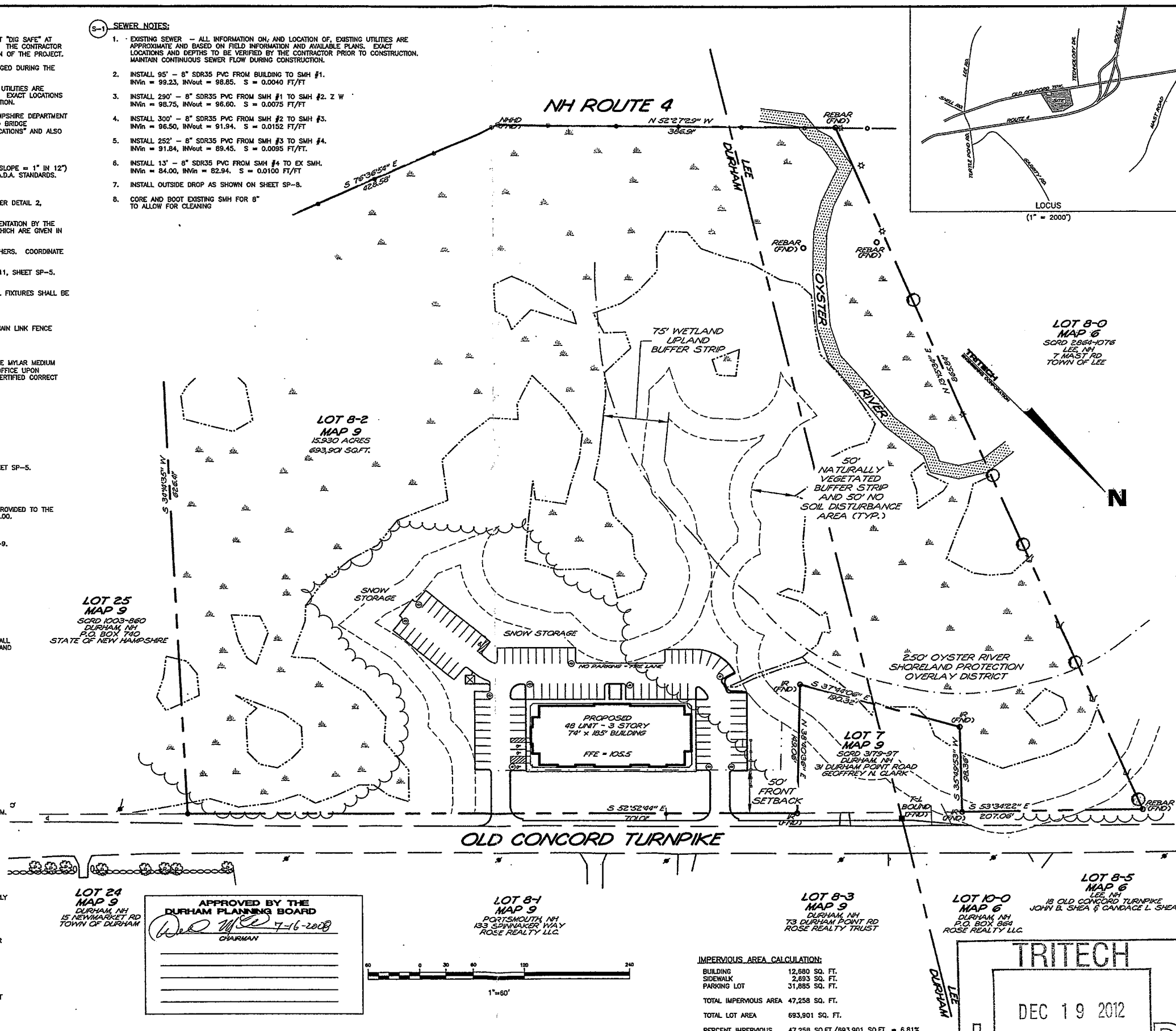

IMPERVIOUS AREA CALCULATION:

BUILDING	12,680 SQ. FT.
SIDEWALK	2,693 SQ. FT.
PARKING LOT	31,885 SQ. FT.
TOTAL IMPERVIOUS AREA	47,258 SQ. FT.
TOTAL LOT AREA	693,901 SQ. FT.
PERCENT IMPERVIOUS	47,258 SQ.FT./693,901 SQ.FT. = 6.81%

TRITECH
ENGINEERING CORPORATION

DATE	DESCRIPTION
07/19/07	GENERAL REVISIONS
08/02/07	ADDED FENCE
08/29/07	REV. PER REVIEW COMMENTS
11/17/08	REV. PER NHDES COMMENTS
02/06/08	REV. PER NHDES COMMENTS
3/05/08	REV. PER TOWN OF DURHAM COMMENTS
6/24/08	REV. PER NHDES COMMENTS



OVERALL DEVELOPMENT PLAN
RIVER'S EDGE APARTMENTS

OLD CONCORD TURNPIKE & ROUTE 4
DURHAM & LEE, NEW HAMPSHIRE
JUNE 20, 2007
JOB NO. 04173
SCALE: 1" = 60'

SHEET NO.

SP-1

TRITECH

DEC 19 2012

ISSUED

785 CENTRAL AVENUE
DOVER, NEW HAMPSHIRE 03830
TELEPHONE 603 742 8707
FAX 603 742 9830