

SITE PLAN REVIEW AMENDED SUBMISSION
GENERAL NOTES:

1. THIS PROJECT WAS APPROVED BY THE DURHAM PLANNING BOARD ON FEBRUARY 10, 2010. THESE AMENDED PLANS REFLECT MINOR CHANGES DESCRIBED IN THE ACCOMPANYING LETTER OF INTENT.

2. TOTAL PROPOSED ONSITE SQUARE FOOTAGE OF IMPERVIOUS AREA = 13,880± SF (66% OF BUILDING=3,440 SF UNDERGROUND SURFCE=10,440 SF PROPERTY):

CONDENSER AREA=140 SF
GENERATOR AREA=84 SF

3. POROUS PAVEMENT AREA=2,183 SF

4. THE PLAN INCLUDES 25 PARKING SPACES, INCLUDING 2 HANDICAP SPACES AND 5 COMPACT SPACES (<30% OF THE 25 SPACES). THE PARKING SPACE NUMBER IS BASED ON THE FUTURE PROJECTED EMPLOYEES.

5. SNOW STORED IN THE RAIN GARDEN AREA SHALL NOT BE STORED WITHIN THE 75' WETLAND BUFFER.

6. SINCE THE FEBRUARY 10, 2010 APPROVAL, THE PROPOSED IMPERVIOUS AREA AT THE SITE HAS DECREASED AND LESS RUNOFF IS PRODUCED. THE STORMWATER MANAGEMENT DESIGN HAS NOT CHANGED FROM THE PREVIOUSLY APPROVED "HYDROLOGIC IMPACT ASSESSMENT" REPORT DATED JANUARY 2010.

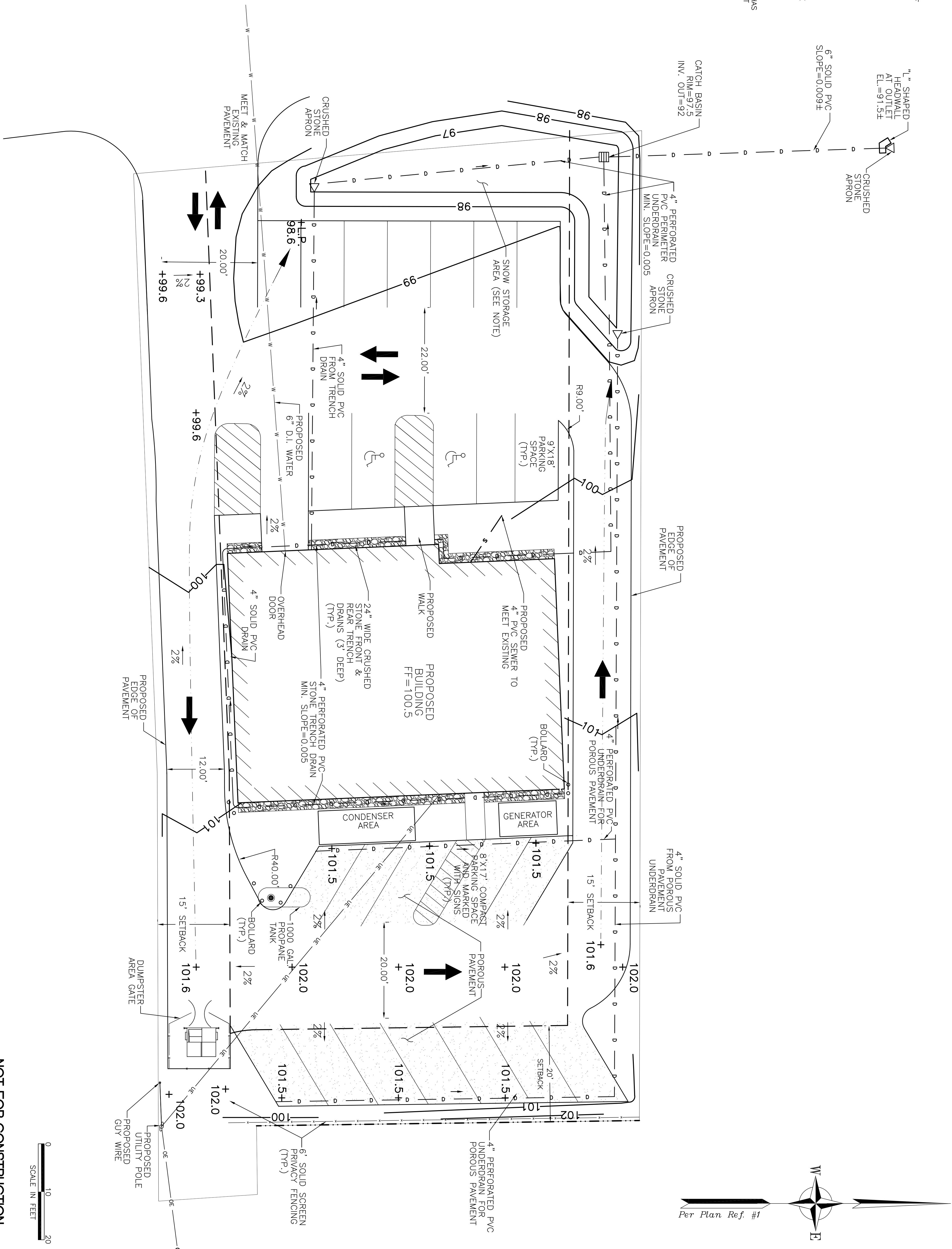

0 10 20
SCALE IN FEET

**NOT FOR CONSTRUCTION
ISSUED FOR REGULATORY REVIEW**

OWNERS AGENT:	
PROJECT NO.:	18574
DESIGNED BY:	MAD
DRAWN BY:	MAD
CHECK BY:	JKM
DATE:	11/30/12
SCALE:	1" = 10'
XEMED HOLDINGS LLC	
AMENDED SITE PLAN REVIEW SUBMISSION	
PROPOSED SITE LAYOUT	
C102	
SHEET 2 OF 3	