

SITE PLAN REVIEW AMENDED SUBMISSION
GENERAL NOTES:

1. THIS PROJECT WAS APPROVED BY THE DURHAM PLANNING BOARD ON FEBRUARY 10, 2010. THESE AMENDED PLANS REFLECT MINOR CHANGES DESCRIBED IN THE ACCOMPANYING LETTER OF INTENT.
2. TOTAL PROPOSED ONSITE SQUARE FOOTAGE OF IMPERVIOUS AREA = 13,789± SF (66% OF PROPERTY):
BUILDING=3,440 SF
IMPERVIOUS PAVEMENT=10,262 SF
CONDENSER AREA=72 SF
GENERATOR AREA=15 SF
3. POROUS PAVEMENT AREA=2,183 SF
4. THE PLAN INCLUDES 24 PARKING SPACES, INCLUDING 2 HANDICAP SPACES AND 5 COMPACT SPACES (<30% OF THE 24 SPACES). THE PARKING SPACE NUMBER IS BASED ON THE FUTURE PROJECTED EMPLOYEES.
5. SNOW STORED IN THE RAIN GARDEN AREA SHALL NOT BE STORED WITHIN THE 75' WETLAND BUFFER.
6. SINCE THE FEBRUARY 10, 2010 APPROVAL, THE PROPOSED IMPERVIOUS AREA AT THE SITE HAS DECREASED AND LESS RUNOFF IS PRODUCED. THE STORMWATER MANAGEMENT DESIGN HAS NOT CHANGED FROM THE PREVIOUSLY APPROVED "HYDROLOGIC IMPACT ASSESSMENT" REPORT DATED JANUARY 2010.

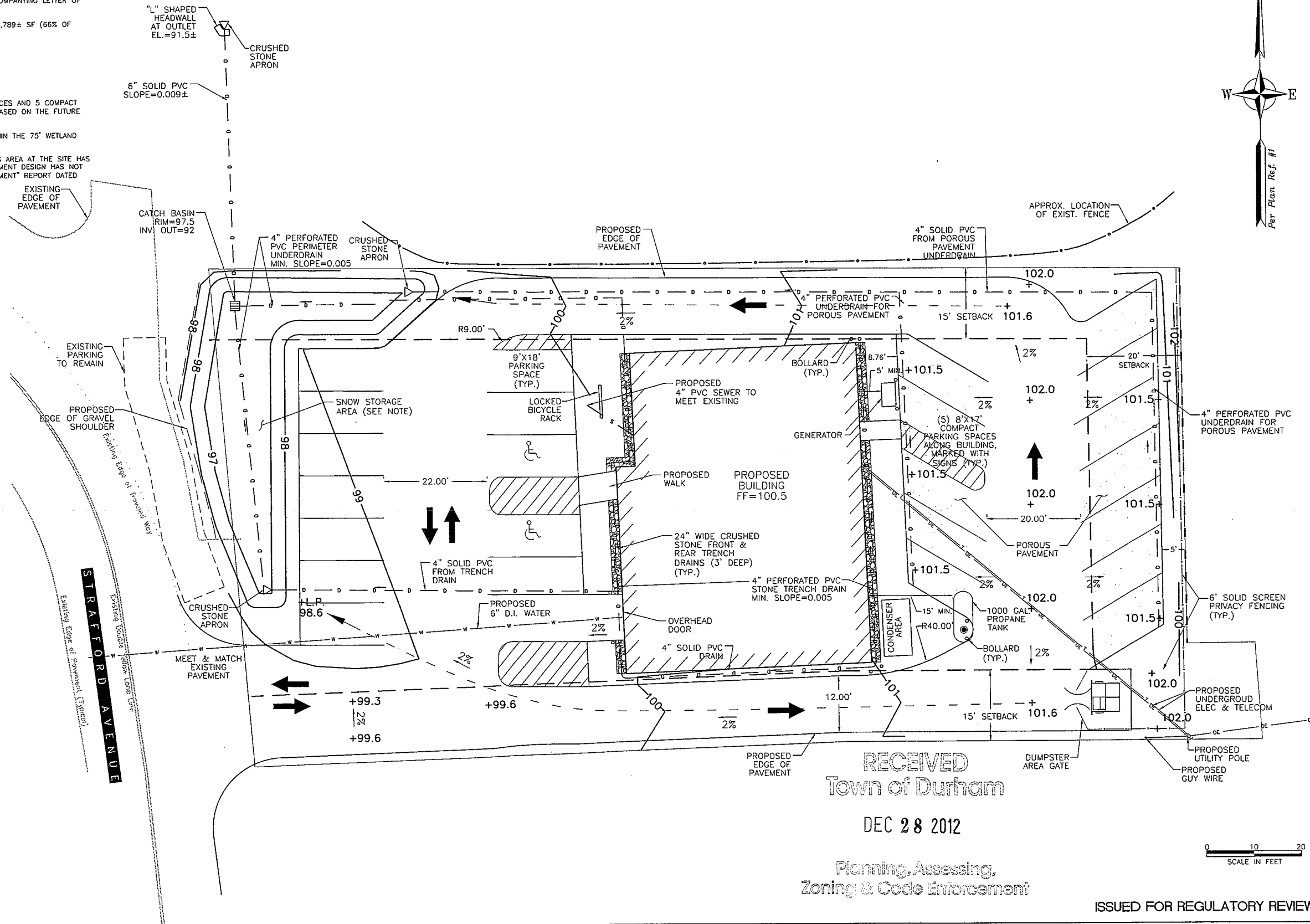

MARK	DATE	DESCRIPTION

OWNER'S AGENT:

CDR MAGUIRE
Architects/Engineers/Planners
195 New Hampshire Ave., Suite 240
Portsmouth, NH 03801

PROJECT NO.:	18874
DESIGNED BY:	MAD
DRAWN BY:	MAD
CHK'D BY:	JKM
DATE:	12/28/12
SCALE:	1" = 10'

XEMED HOLDINGS LLC
AMENDED SITE PLAN REVIEW SUBMISSION
PROPOSED SITE LAYOUT

SHEET NO.
C101
SHEET 1 OF 2

ISSUED FOR REGULATORY REVIEW

SITE PLAN REVIEW SUBMISSION
LANDSCAPING NOTES:

NO.	KEY:	TYPE:	COMMON NAME:	SIZE:
5	VB	VIBURNUM X BURKWOODII	BURKWOOD VIBURNUM	3'-4' B&B
7	JC	JUNIPERUS CHINENSIS 'PLUMOSA COMPACTA'	COMPACT ANDORRA JUNIPER	18"-24" TALL
3	AE	AZALEA EVERGREEN VARIETY	EVERGREEN AZALEA	24"-30" TALL
8	BN	BETULA NIGRA	RIVER BIRCH	10'-12' CLUMP
12	HS	HIBISCUS SYRIACUS	ROSE OF SHARON	4'-5' B&B
6	IV	ILEX VERTICILLATA	WINTERBERRY	3'-4' B&B

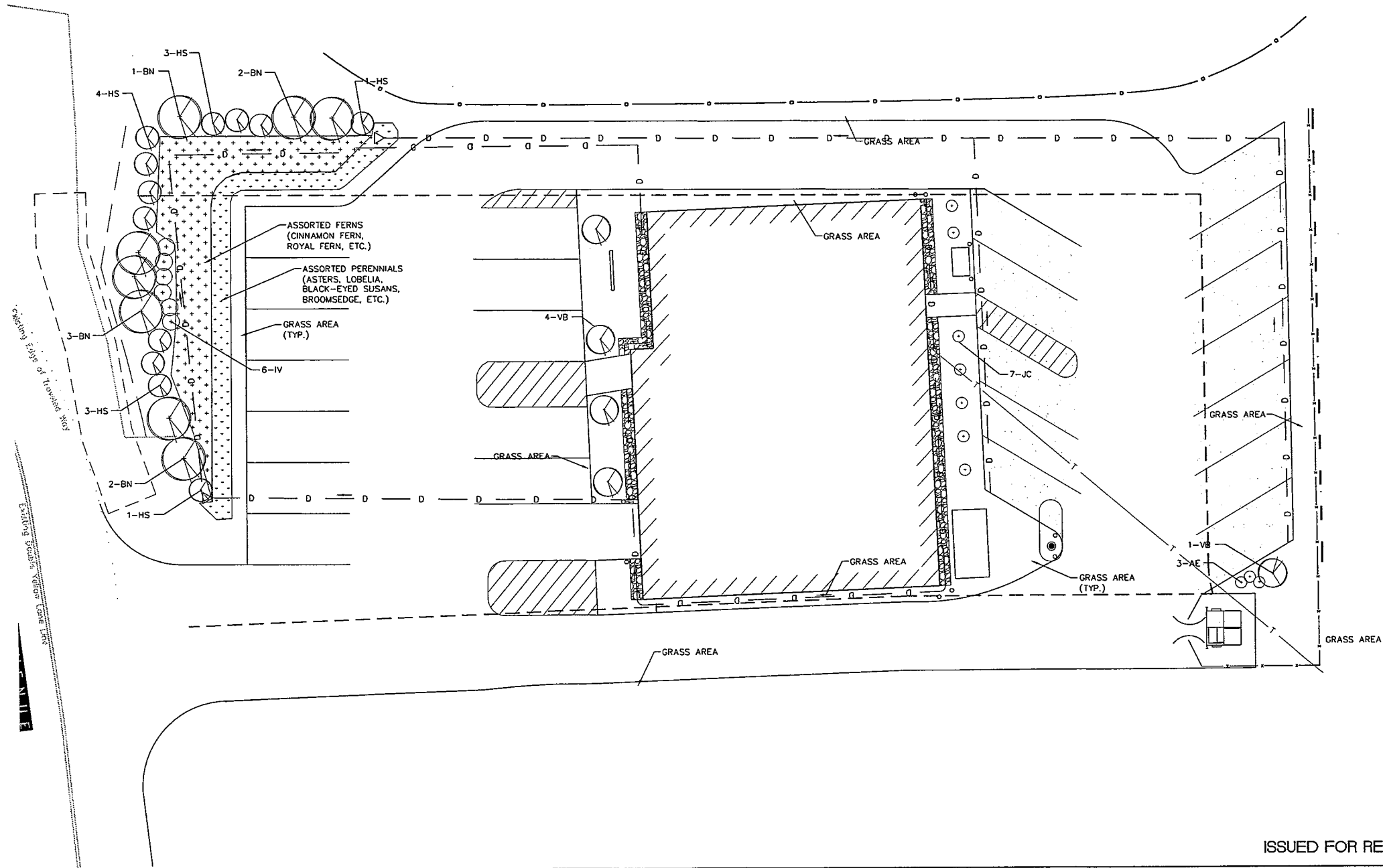

0 10 20
SCALE IN FEET

ISSUED FOR REGULATORY REVIEW

MARK	DATE	DESCRIPTION

OWNER'S AGENT:



CDR MAGUIRE
Architects/Engineers/Planners
195 New Hampshire Ave., Suite 240
Portsmouth, NH 03801

PROJECT NO.:	18874
DESIGNED BY:	CAW
DRAWN BY:	CAW
CHK'D BY:	DBF
DATE:	12/28/12
SCALE:	1" = 10'

XEMED HOLDINGS LLC
AMENDED SITE PLAN REVIEW SUBMISSION
PROPOSED LANDSCAPING PLAN

SHEET NO.
L101
SHEET 2 OF 2