

TAX MAP 14 LOT 25-2
N/F
STUART W CURTIS
BK 3240 PG 545

TAX MAP 14 LOT 21-1
N/F
GEORGE HOWARD BURROWS &
DEBORAH S. BURROWS
BK 3405 PG 567
(Southeast Land Trust of New Hampshire,
Book 3564 Page 433)

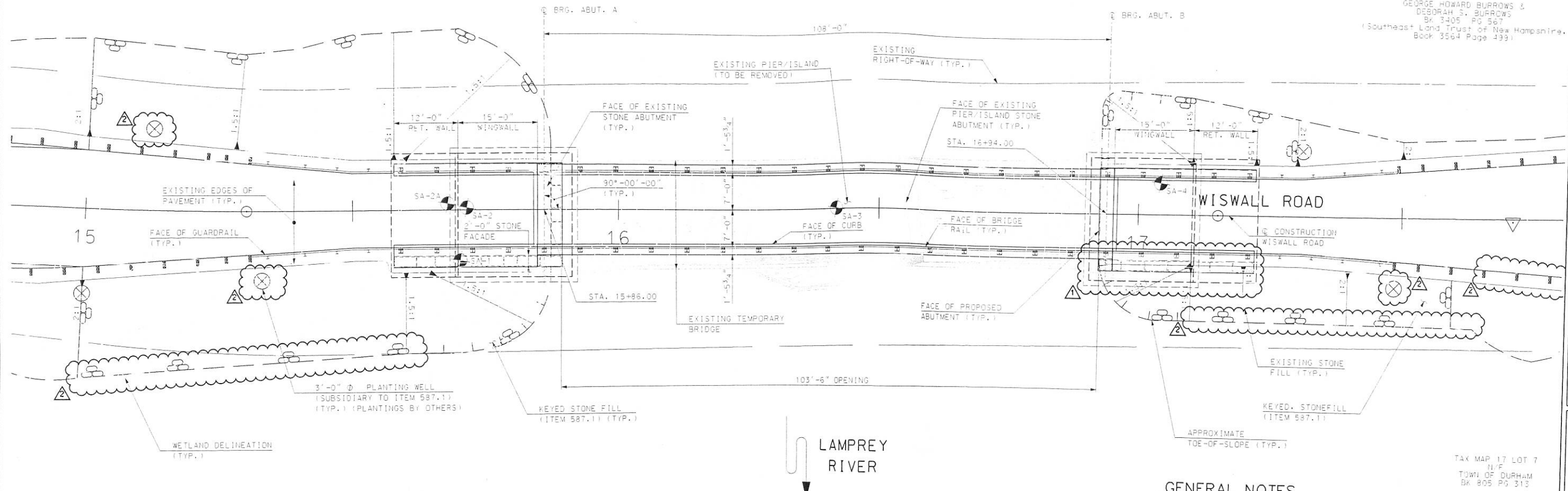

TAX MAP 17 LOT 7
N/F
TOWN OF DURHAM
BK 805 PG 313

TAX MAP 17 LOT 7
N/F
TOWN OF DURHAM
BK 805 PG 313

BRIDGE PLAN
SCALE: 1" = 10'-0"

HYDRAULIC DATA

1. DRAINAGE AREA: 182 SQ. MI.
2. DESIGN FLOOD: Q100 = 9982 CFS
3. DESIGN VELOCITY: 7.6 FPS
4. DESIGN FLOOD HEIGHT: EL. 82.0'
5. BRIDGE WATERWAY OPENING:
PROPOSED: 147' 50" FT
EXISTING: 889' 50" FT

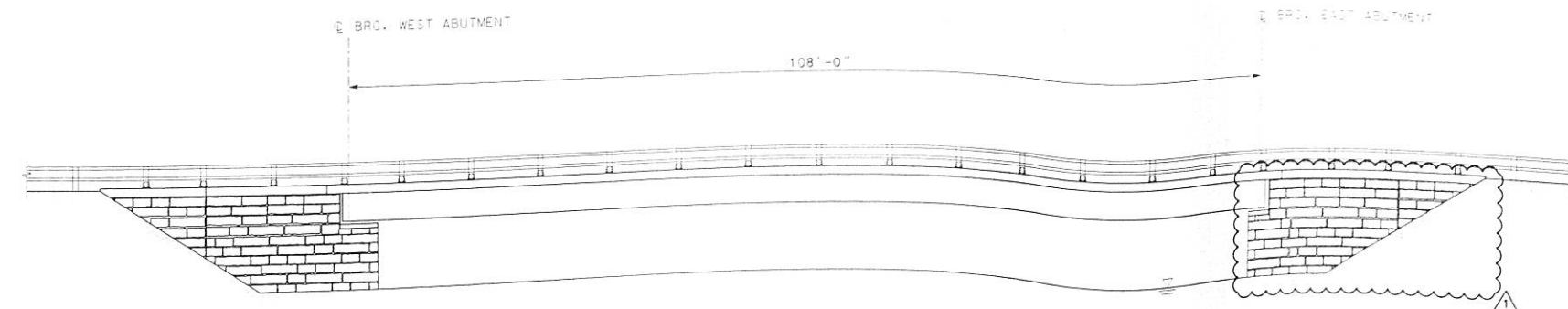

ELEVATION
SCALE: 1" = 10'-0"

GENERAL NOTES

1. DESIGN LOADING: HL-93 AASHTO LIVE LOAD
2. DESIGN METHOD: LOAD AND RESISTANCE FACTOR DESIGN
3. SPECIFICATIONS: 2007 AASHTO LRFD BRIDGE DESIGN SPECIFICATIONS AS AMENDED
2006 NHDOT STANDARD SPECIFICATIONS AS AMENDED
4. FOUNDATION DATA: SPREAD FOOTING ON TREMIE SEAL ON BEDROCK (ALLOWABLE SOIL PRESSURE = 40.0 TSF)
SPREAD FOOTING ON SOIL (ALLOWABLE BEARING PRESSURE = 2.0 TSF)
5. REINFORCING STEEL: AASHTO M 31M (ASTM A 615) GRADE 60
6. CONCRETE: PRECAST PRESTRESSED BEAM UNITS: $f'_c = 6,000$ PSI
CAST-IN-PLACE: $f'_c = 4,500$ PSI
 $f'_c = 3,000$ PSI
7. SEISMIC PERFORMANCE CATEGORY B; A = 0.09
8. REMOVAL OF THE EXISTING BRIDGE STRUCTURE SHALL INCLUDE REMOVAL OF THE EXISTING SUPERSTRUCTURE, STONE AND CONCRETE ABUTMENTS, AND STONE/EARTHEN PIER IN THEIR ENTIRETY. REMOVAL OF THE EXISTING STRUCTURE SHALL BE PAID FOR UNDER ITEM 502. REMOVAL OF EXISTING BRIDGE STRUCTURE. (SEE NOTES ON SHEET 10)
9. LIMITS OF CLEARING AND GRUBBING SHALL BE 5 FEET FROM THE PROPOSED LIMITS OF WORK, UNLESS OTHERWISE SHOWN OR DIRECTED BY THE ENGINEER.
10. ALL EXISTING BRONZE DISCS REPRESENTING STATE BENCHMARKS OR SURVEY TRIANGULATION POINTS MUST NOT BE DISTURBED. WHEN THE WORK CALLED FOR INVOLVES DISTURBING A BRONZE DISC THE CONTRACTOR SHALL NOTIFY THE ENGINEER SUFFICIENTLY IN ADVANCE OF THE WORK TO PERMIT THE STATE TO TEMPORARILY RELOCATE THE AFFECTED MARKER.
11. CONTRACTOR SHALL PREPARE EROSION AND SEDIMENT CONTROL AND STOPWATER MANAGEMENT PLAN, ITEM 645.7. PLANS SHALL BE REVIEWED AND APPROVED BY THE ENGINEER AND NHDOT AND OTHER PARTIES IN ACCORDANCE WITH WETLAND PERMIT REQUIREMENTS PRIOR TO ANY WORK ON SITE.
12. THE EXISTING ABUTMENT AND PIER STONES SHALL BE SALVAGED. EXISTING ABUTMENT AND PIER RADIA STONES SHALL BE USED TO CONSTRUCT THE PROPOSED STONE FACADE.

12/09	STONE FACADE AT SE SIDE					
6/10	AS-BUILT REVISIONS					
NO.	DATE	REVISION	DRAWN:	DESIGNED:	CHECKED:	APPROVED:

CONSULTING ENGINEERS
Inc.
540 Commercial Street-Manchester, NH 03101
(603) 668-8222-Fax: (603) 668-8902
cd@cldeengineers.com www.cldeengineers.com

TOWN OF DURHAM, NH
DEPARTMENT OF PUBLIC WORKS
100 STONE QUARRY DRIVE
DURHAM, NH 03824

WISWALL ROAD OVER
THE LAMPREY RIVER
BRIDGE NO. 070/073
STATE PROJECT NO. 14453
BRIDGE PLAN & ELEVATION

SCALE: 1" = 10'	JOB NO. 07-0118
DATE: 7/09	DWG. 8